

- DRAWING NOTES:**
- 10-WAY 4" PVC CONCRETE ENCASED COMMUNICATIONS DUCTBANK UNDER BUILDING. SEE DETAIL #3 THIS SHEET.
 - PROVIDE 1" CONDUIT FROM SITE SIGN JUNCTION BOX TO BELOW GRADE JUNCTION BOX.
 - PROVIDE EXTERIOR JUNCTION BOX/HANDHOLE. REFER TO DETAIL #2 THIS SHEET
 - COORDINATE EXACT LOCATION WITH TELEPHONE AND CABLE TV UTILITIES.
 - PROVIDE (4) 4" DIRECT BURIED CONDUITS. REFER TO DETAIL #1 THIS SHEET.
 - PROVIDE BELOW GRADE JUNCTION BOX, PER UTILITY COMPANY REQUIREMENTS..
 - PROVIDE (10) 4" DIRECT BURIED CONDUITS.
 - PROVIDE (2) 4" DIRECT BURIED CONDUITS.
 - PROVIDE (4) 4" DIRECT BURIED CONDUITS.
 - PROVIDE (6) 4" DIRECT BURIED CONDUITS. SEE DETAIL #1.
 - ALL WORK INCLUDED IN SITE INFRASTRUCTURE PROJECT.
 - WORK INCLUDED IN THIS PROJECT'S SCOPE OF WORK.

- GENERAL NOTES:**
- INFORMATION SHOWN ON THIS DRAWING PERTAINING TO EXISTING CONDITIONS HAS BEEN OBTAINED FROM AVAILABLE BUILDING DRAWINGS OR GENERAL FIELD OBSERVATIONS AND MY NOT INDICATE ACTUAL EXISTING CONDITIONS IN DETAIL OR DIMENSION. THE CONTRACTOR IS RESPONSIBLE FOR DETERMINING THE ACTUAL EXISTING CONDITIONS PRIOR TO FABRICATION OR PERFORMANCE OF ANY WORK. SHOULD CONDITIONS BE DISCOVERED THAT PREVENT EXECUTION OF THE WORK AS INDICATED, THE CONTRACTOR SHALL IMMEDIATELY NOTIFY THE ARCHITECT IN WRITING AND AWAIT DIRECTION BEFORE PROCEEDING WITH THE WORK.
 - UTILITY COMPANIES ARE RESPONSIBLE FOR BRINING IN ALL UTILITIES (TELEPHONE, CABLE AND DATA) TO THE NEW UTILITY POLE LOCATION. THE ELECTRICAL CONTRACTOR IS RESPONSIBLE FOR EXTENDING THE INDICATED CONDUITS FROM THE NEW UTILITY POLE LOCATION TO THE BUILDING.

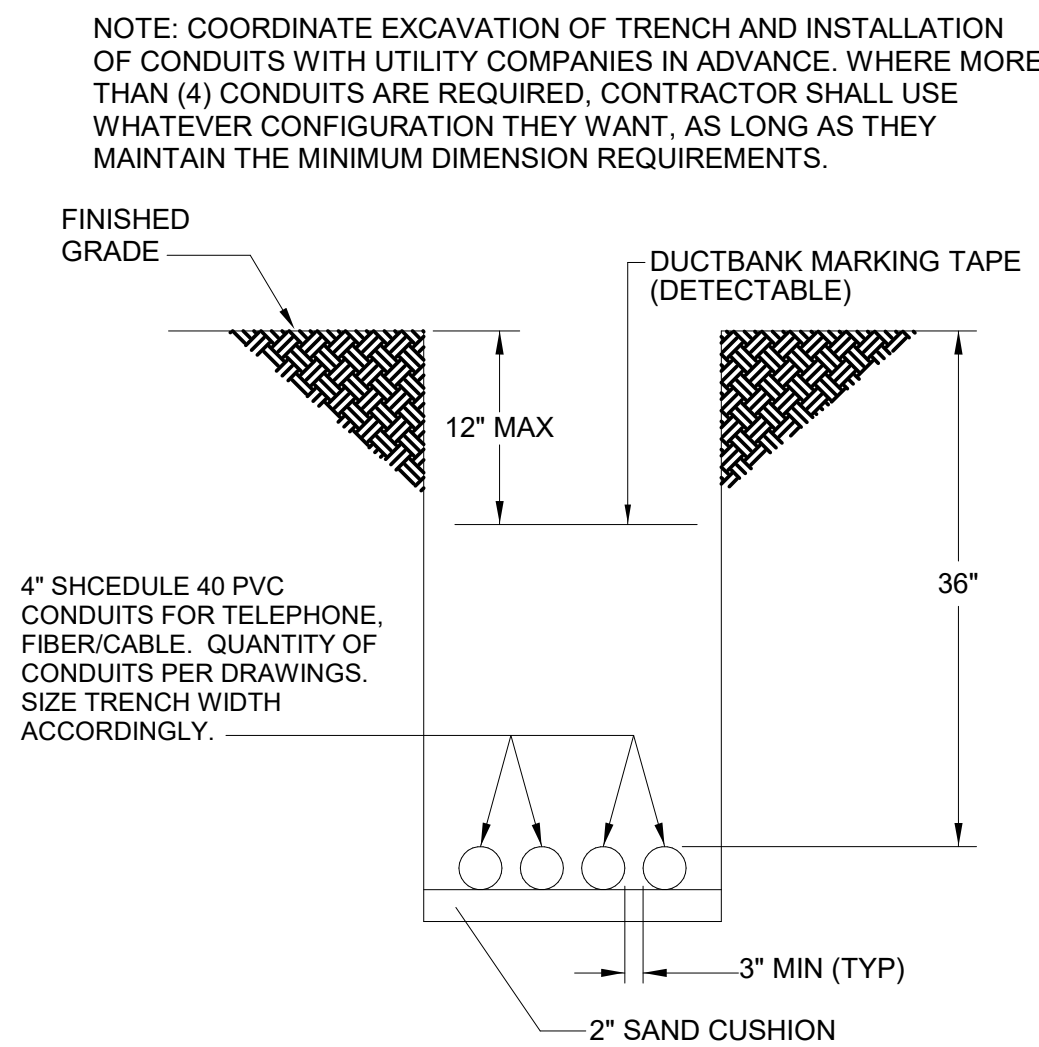

1 TYPICAL DIRECT BURIED CONDUIT DETAIL
NO SCALE

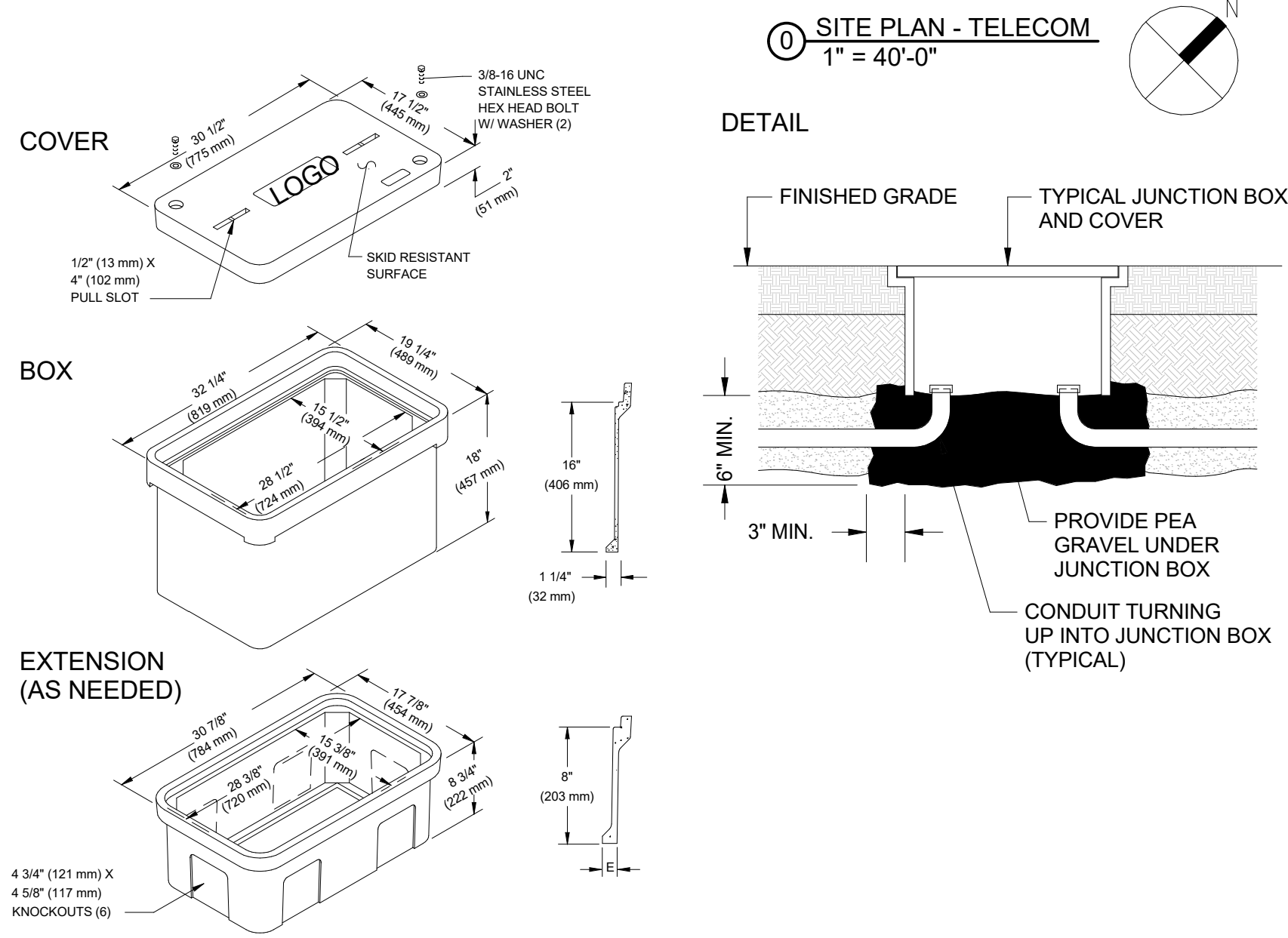

2 TYPICAL BELOW GRADE JUNCTION BOX DETAIL
NO SCALE

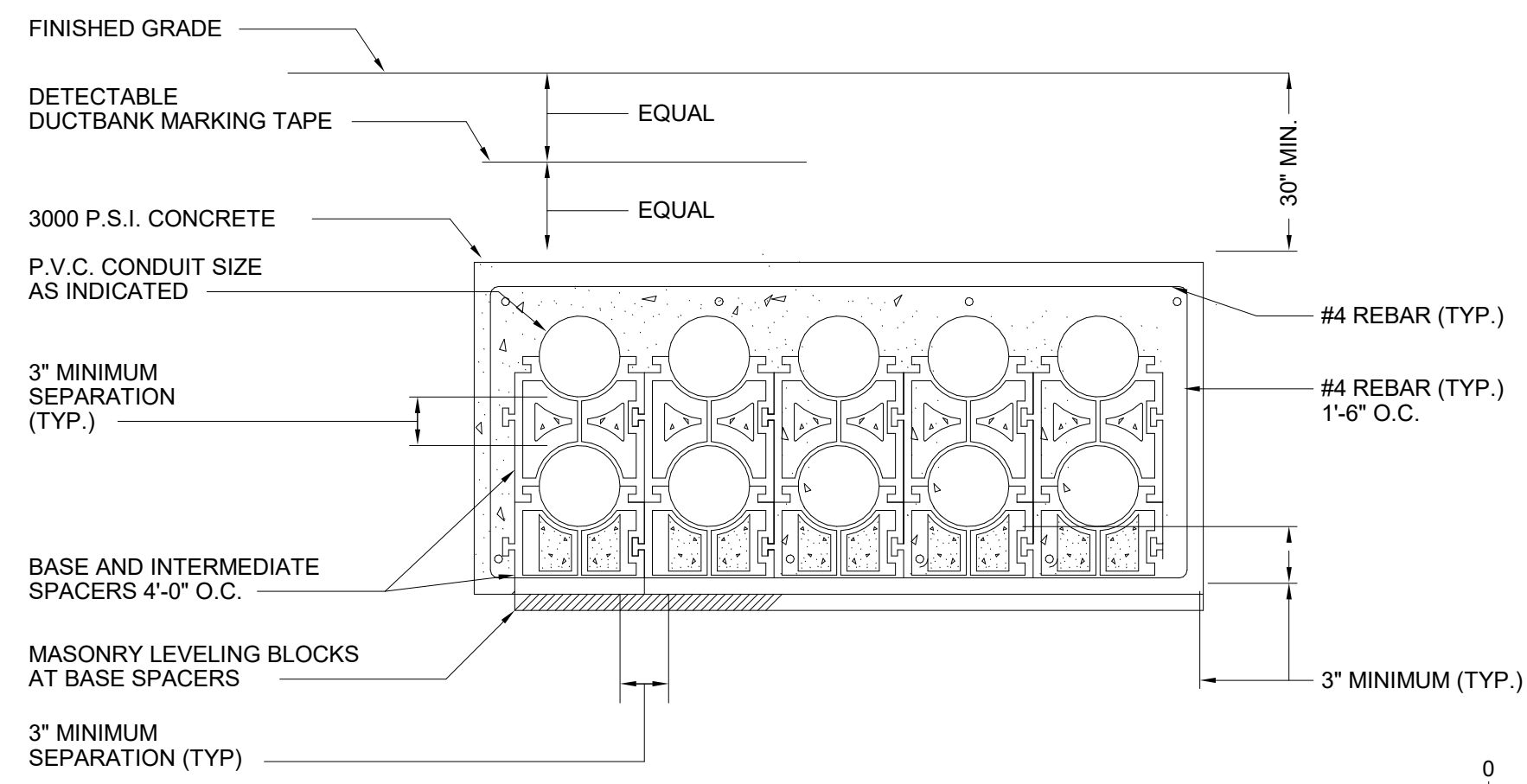

3 10-WAY CONCRETE ENCASED DUCTBANK DETAIL
NO SCALE

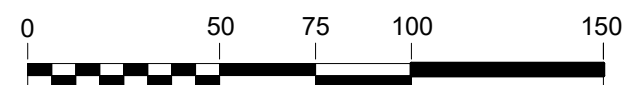

ALL REPORTS, PLANS SPECIFICATIONS AND COMPUTER FILES RELATING TO THIS PROJECT ARE THE PROPERTY OF CRABTREE, ROHRBAUGH & ASSOCIATES. CRABTREE ROHRBAUGH & ASSOCIATES RETAINS ALL COMMON LAW, STATUTE AND OTHER RESERVED RIGHTS INCLUDING THE COPYRIGHT THEREIN. REPRODUCTION OF THE MATERIAL HEREIN OR SUBSTANTIAL USE WITHOUT WRITTEN PERMISSION OF CRABTREE, ROHRBAUGH & ASSOCIATES VIOLATES THE COPYRIGHT LAWS OF THE UNITED STATES AND WILL BE SUBJECT TO LEGAL PROSECUTION. © CRABTREE, ROHRBAUGH & ASSOCIATES, INC. 2019

REVISIONS

NO.	MM-DD-YR	NAME	DESCRIPTION OF CHANGES
1	12/18/2019		BID DOCUMENTS

CRABTREE ROHRBAUGH & ASSOCIATES - ARCHITECTS

100 WEST ROAD, SUITE 402, TOWSON MD 21204 410-528-0272
MECHANICSBURG, PENNSYLVANIA CHARLOTTEVILLE, VIRGINIA WHITE SULPHUR SPRINGS, WEST VIRGINIA

www.cra-architects.com

PROPOSED NEW

WASHINGTON COUNTY PUBLIC SAFETY TRAINING CENTER

WASHINGTON COUNTY PROJECT NO. 28-266

18350 PUBLIC SAFETY PLACE
HAGERSTOWN, MD 21740



SITE PLAN - TELECOM

PLOT SCALE:

As Indicated

FILENAME:

DATE:

DECEMBER 18, 2019

PROJECT
3089

T0.2

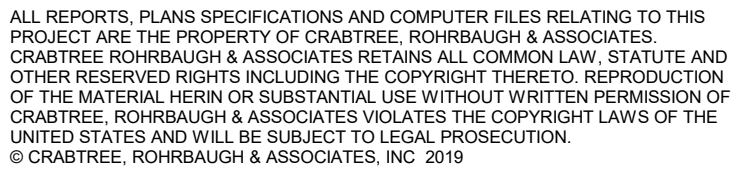
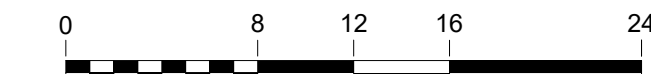
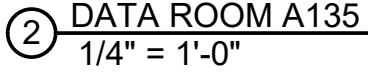

- R
Q

[illegible]

100 WEST ROAD, SUITE 402, TOWSON MD 21204 410-528-0272
www.cra-architects.com

PROPOSED NEW
WASHINGTON COUNTY PUBLIC SAFETY TRAINING CENTER
WASHINGTON COUNTY PROJECT NO. 28-266
18350 PUBLIC SAFETY PLACE
HAGERSTOWN, MD 21740

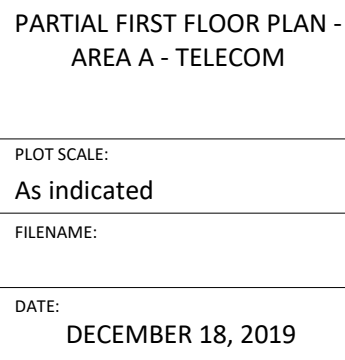

T1.1



ALL REPORTS, PLANS SPECIFICATIONS AND COMPUTER FILES RELATING TO THIS PROJECT ARE THE PROPERTY OF CRABTREE, ROHRBAUGH & ASSOCIATES. CRABTREE ROHRBAUGH & ASSOCIATES RETAINS ALL COMMON LAW, STATUTE AND OTHER RESERVED RIGHTS INCLUDING THE COPYRIGHT THEREIN. REPRODUCTION OF THE MATERIAL HEREIN OR SUBSTANTIAL USE WITHOUT WRITTEN PERMISSION OF CRABTREE, ROHRBAUGH & ASSOCIATES VIOLATES THE COPYRIGHT LAWS OF THE UNITED STATES AND WILL BE SUBJECT TO LEGAL PROSECUTION. © CRABTREE, ROHRBAUGH & ASSOCIATES, INC. 2019

REVISIONS

NO.	MM-DD-YR	NAME	DESCRIPTION OF CHANGES
1	12/18/2019		BID DOCUMENTS

CRABTREE ROHRBAUGH & ASSOCIATES -

ARCHITECTS

100 WEST ROAD, SUITE 402, TOWSON MD 21204 410-528-0272
MECHANICSBURG, PENNSYLVANIA CHARLOTTEVILLE, VIRGINIA WHITE SULPHUR SPRINGS, WEST VIRGINIA

www.cra-architects.com

PROPOSED NEW

WASHINGTON COUNTY PUBLIC SAFETY TRAINING CENTER

WASHINGTON COUNTY PROJECT NO. 28-266

18350 PUBLIC SAFETY PLACE
HAGERSTOWN, MD 21740



PARTIAL FIRST FLOOR PLAN -
AREA B - TELECOM

PLOT SCALE:
As indicated

FILENAME:

DATE:
DECEMBER 18, 2019

PROJECT
3089

T1.2

KEYED NOTES:

- 1 MOUNT 54" AFF FOR OWNER TIME CARD CLOCK (KRONOS).
- 2 MOUNT 48" AFF.
- 3 MOUNT 10' AFF.
- 4 PROVIDE DATA OUTLETS FOR CONNECTION TO TWO ELECTRIC METERS. COORDINATE EXACT LOCATION IN FIELD.
- 5 MOUNT 8" AFF ON WALL.
- 6 MOUNT ADJACENT TO SOUND CABINET.
- 7 MOUNT HIGH ON WALL BEHIND VIDEO DISPLAY. COORDINATE EXACT LOCATION IN FIELD.
- 8 PROVIDE (3) 4" C ABOVE CEILING FOR LOW VOLTAGE CABLING PATH ABOVE HARD CEILING.
- 9 PROVIDE TELEPHONE OUTLET INSIDE FLUSH MOUNTED TELEPHONE ENCLOSURE. MOUNT AT 48" AFF.
- 10 PROVIDE 48" AFF WALL VOIP TELEPHONE OUTLET.
- 11 AT THIS LOCATION PROVIDE CHANGE IN ELEVATION FOR CONDUITS SLOPING TO MATCH CABLE TRAY IN CORRIDOR B15.
- 12 PROVIDE TELECOM RACK (2 POST).
- 13 PROVIDE 18" WIDE LADDER TRAY.
- 14 PROVIDE 4" EZ PATH SLEEVES.
- 15 PROVIDE 3/4" FIRE RATED PLYWOOD (3 WALLS).

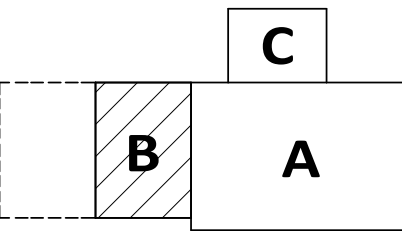
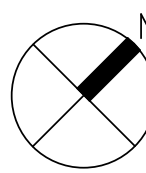
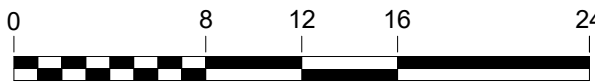
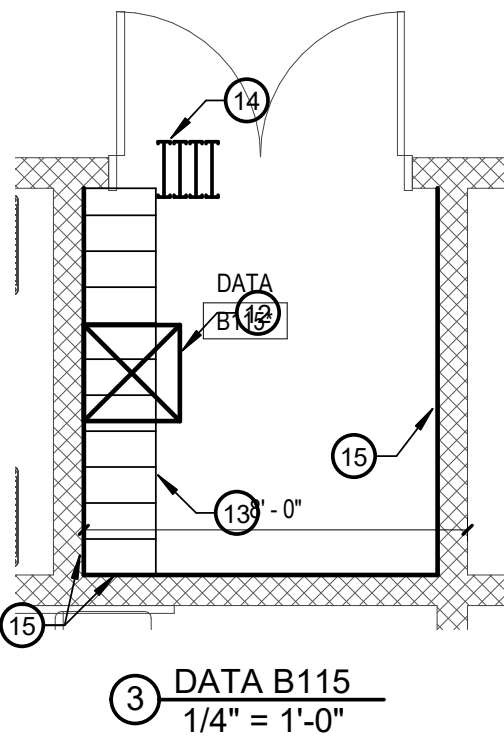

KEY PLAN

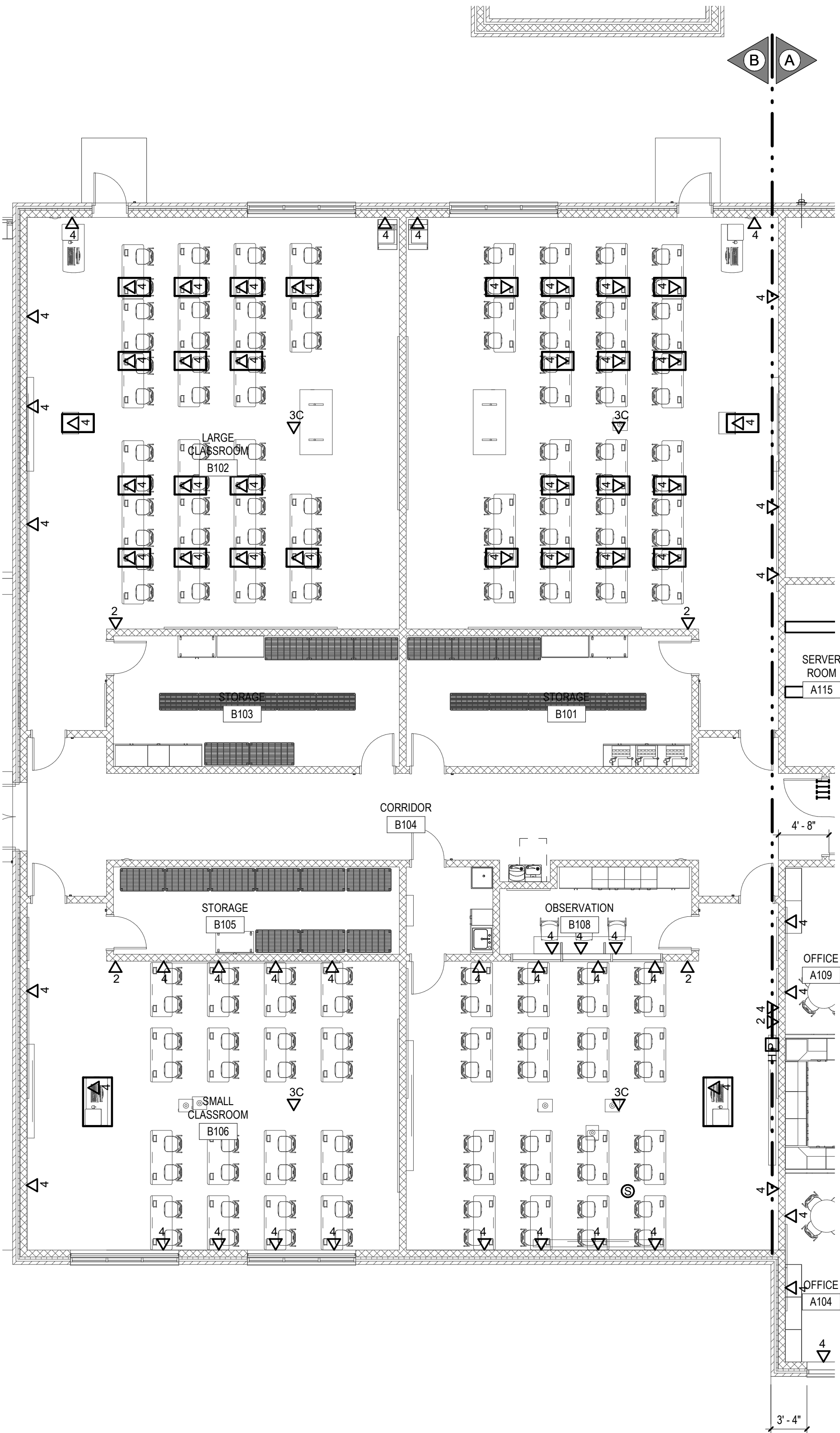

1 PARTIAL FIRST FLOOR PLAN - AREA B - TELECOM
1/8" = 1'-0"

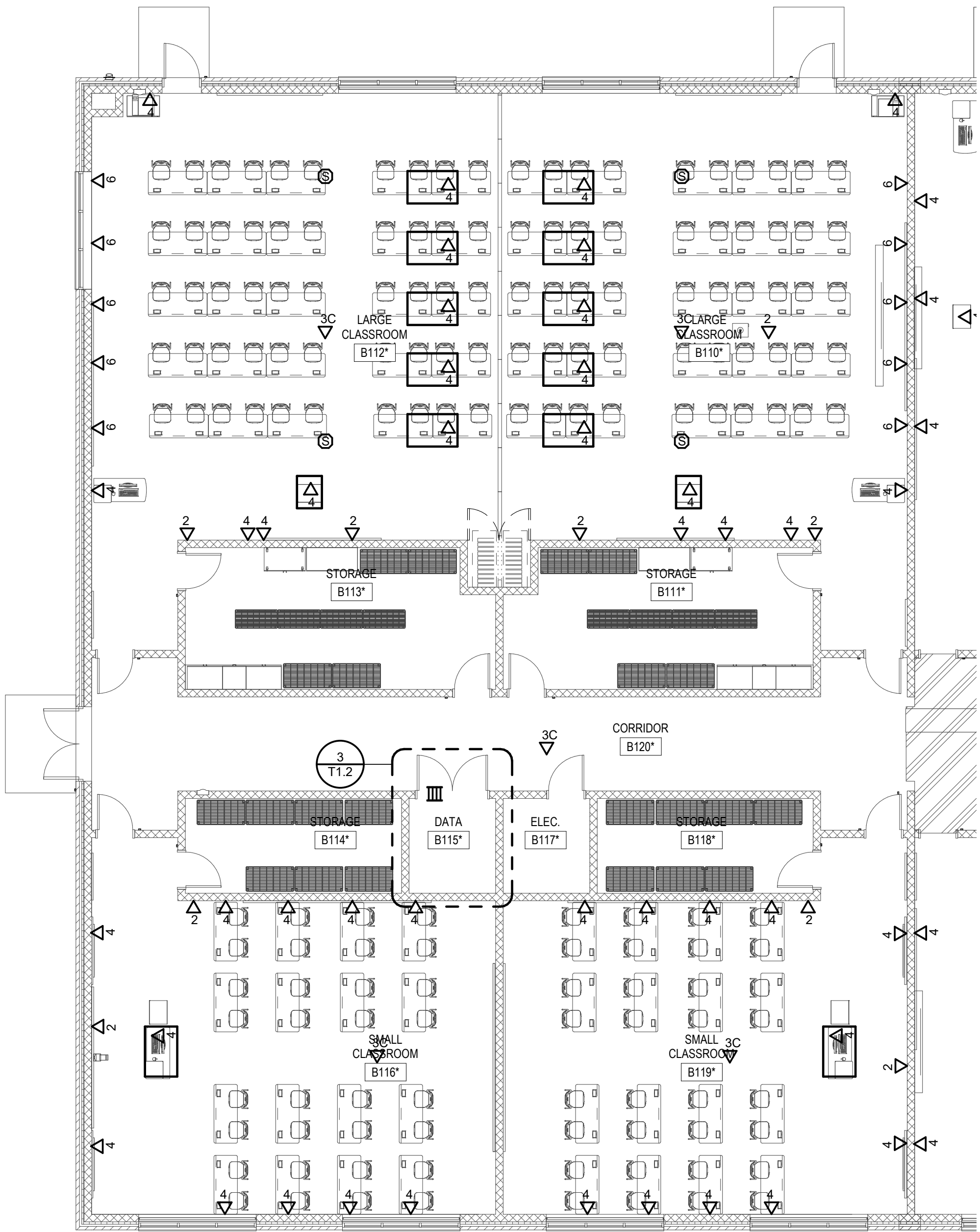

2 PARTIAL FIRST FLOOR PLAN - AREA B ALT - TELECOM
1/8" = 1'-0"

1. WHERE CABLING CANNOT BE CONCEALED FROM VIEW, PROVIDE PAINTED CONDUITS FOR CABLING RUNNING IN EXPOSED CEILING AREAS INCLUDING MULTIPURPOSE ROOM C100.

- ① MOUNT 10'-0" AFF.
- ② MOUNT IN FLUSH FLOOR BOX IN CONCRETE FLOOR SLAB.
- ③ PROVIDE (2) 1 1/4" C FOR TELECOM CABLES FROM ACCESSIBLE CEILING SPACE TO FLOOR BOX.

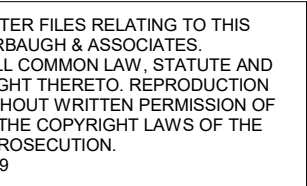
[illegible]

ALL REPORTS, PLANS, SPECIFICATIONS AND COMPUTER FILES RELATING TO THIS PROJECT ARE THE PROPERTY OF CRABTREE, ROHRBAUGH & ASSOCIATES. CRABTREE ROHRBAUGH & ASSOCIATES RETAINS ALL COMMON LAW, STATUTE AND OTHER RESERVED RIGHTS INCLUDING THE COPYRIGHT THEREO. REPRODUCTION OF THE MATERIAL HEREIN OR SUBSTANTIAL USE WITHOUT WRITTEN PERMISSION OF CRABTREE, ROHRBAUGH & ASSOCIATES VIOLATES THE COPYRIGHT LAWS OF THE UNITED STATES AND WILL BE SUBJECT TO LEGAL PROSECUTION.
© CRABTREE, ROHRBAUGH & ASSOCIATES, INC 2019

100 WEST ROAD, SUITE 402, TOWSON MD 21204 410-528-0272 www.cra-architects.com
MECHANICSBURG, PENNSYLVANIA CHARLOTTESVILLE, VIRGINIA WHITE SULPHUR SPRINGS, WEST VIRGINIA

WASHINGTON COUNTY PUBLIC SAFETY TRAINING CENTER

18350 PUBLIC SAFETY PLACE
HAGERSTOWN, MD 21740

<p>PARTIAL FIRST FLOOR PLAN - AREA C - TELECOM</p>	
<p>PLOT SCALE:</p> <p>1/8" = 1'-0"</p>	
<p>FILENAME:</p>	
<p>DATE:</p> <p>DECEMBER 18, 2019</p>	

T1.3

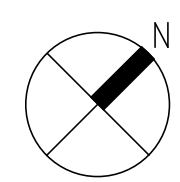

DRAWING NOTES:

1 MOUNT ON WALL AT 10'-0" AFF BELOW ACOUSTIC WALL PANELS.



ALL REPORTS, PLANS SPECIFICATIONS AND COMPUTER FILES RELATING TO THIS PROJECT ARE THE PROPERTY OF CRABTREE, ROHRBAUGH & ASSOCIATES. CRABTREE ROHRBAUGH & ASSOCIATES RETAINS ALL COMMON LAW, STATUTE AND OTHER RESERVED RIGHTS INCLUDING THE COPYRIGHT THEREIN. REPRODUCTION OF THE MATERIAL HEREIN OR SUBSTANTIAL USE WITHOUT WRITTEN PERMISSION OF CRABTREE, ROHRBAUGH & ASSOCIATES VIOLATES THE COPYRIGHT LAWS OF THE UNITED STATES AND WILL BE SUBJECT TO LEGAL PROSECUTION. © CRABTREE, ROHRBAUGH & ASSOCIATES, INC. 2019

REVISIONS

NO.	MM-DD-YR	NAME	DESCRIPTION OF CHANGES
1	12/18/2019		BID DOCUMENTS

CRABTREE ROHRBAUGH & ASSOCIATES -

ARCHITECTS

100 WEST ROAD, SUITE 402, TOWSON MD 21204 410-528-0272
MECHANICSBURG, PENNSYLVANIA CHARLOTTEVILLE, VIRGINIA WHITE SULPHUR SPRINGS, WEST VIRGINIA

www.cra-architects.com

PROPOSED NEW

WASHINGTON COUNTY PUBLIC SAFETY TRAINING CENTER

WASHINGTON COUNTY PROJECT NO. 28-266

18350 PUBLIC SAFETY PLACE
HAGERSTOWN, MD 21740



PARTIAL FIRST FLOOR PLAN -
AREA A - SECURITY

PLOT SCALE:
1/8" = 1'-0"
FILENAME:
DATE:
DECEMBER 18, 2019

PROJECT
3089

T2.1

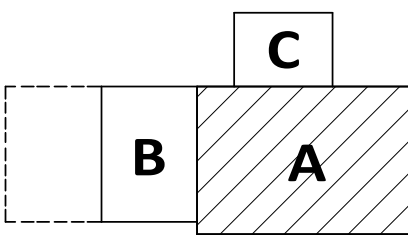
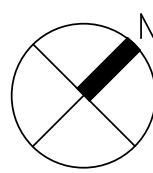
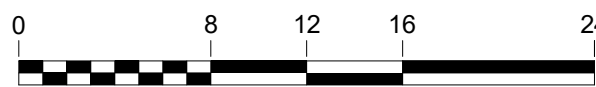
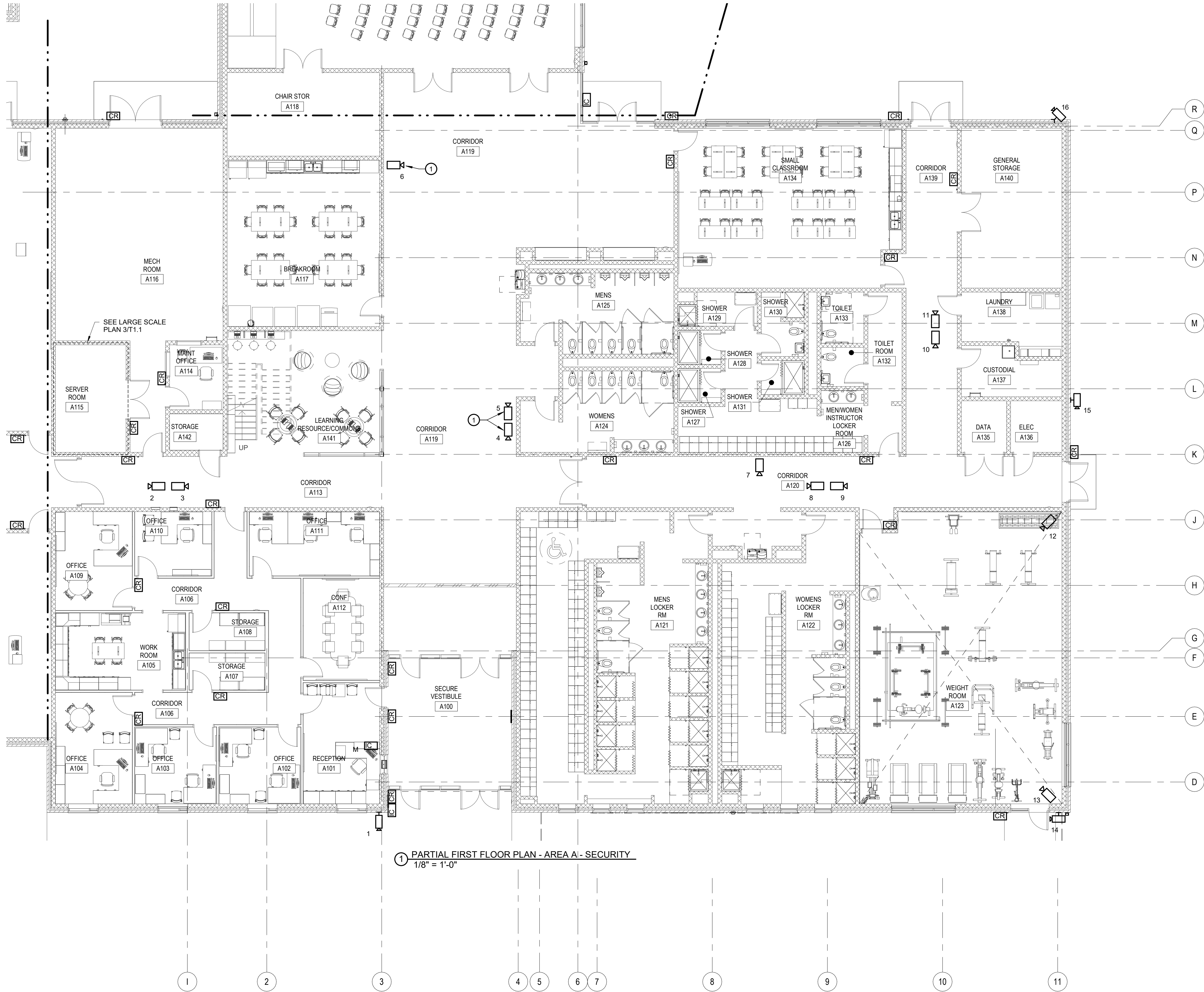

KEY PLAN

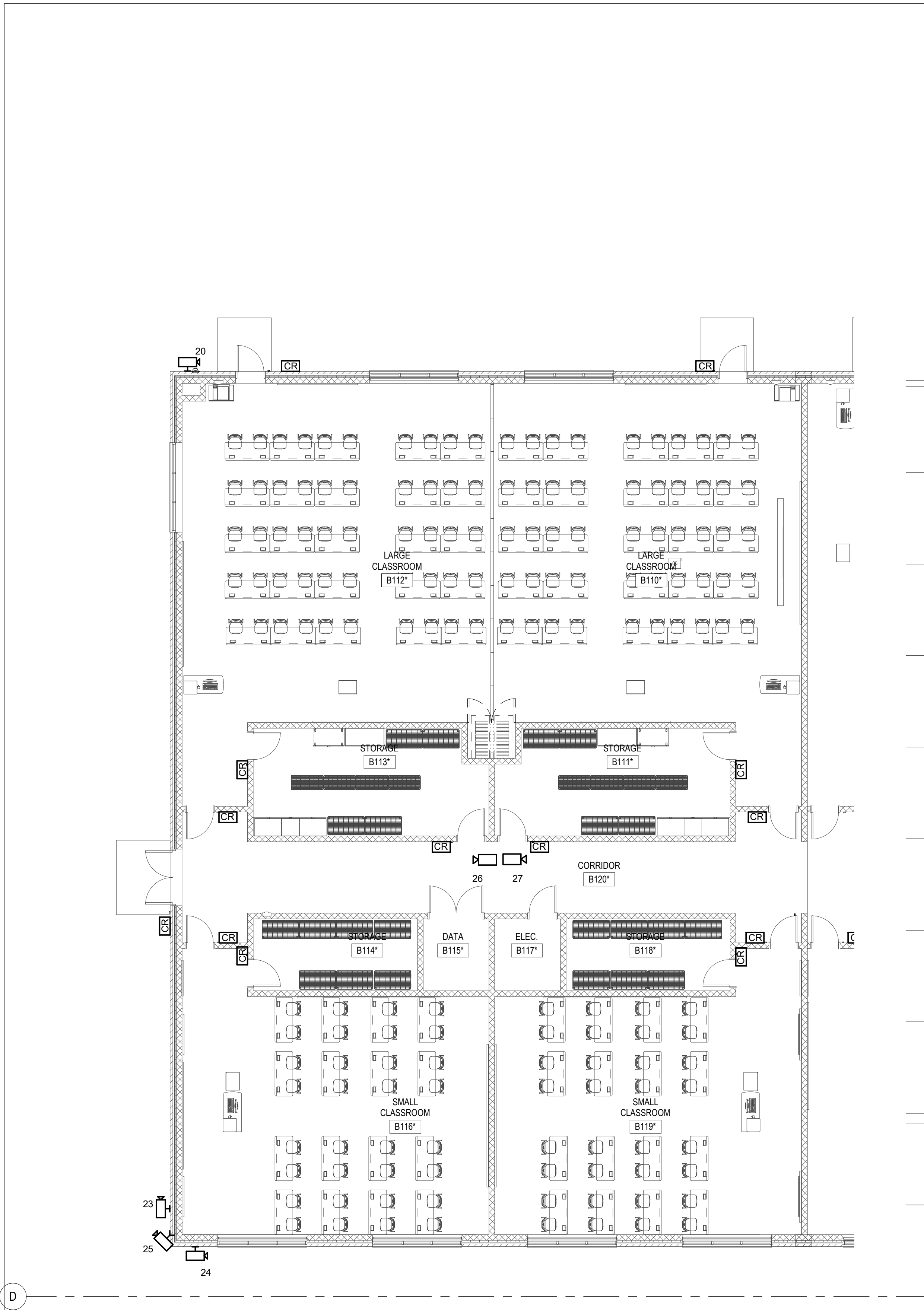

② PARTIAL FIRST FLOOR PLAN - AREA B ALT - SECURITY
1/8" = 1'-0"

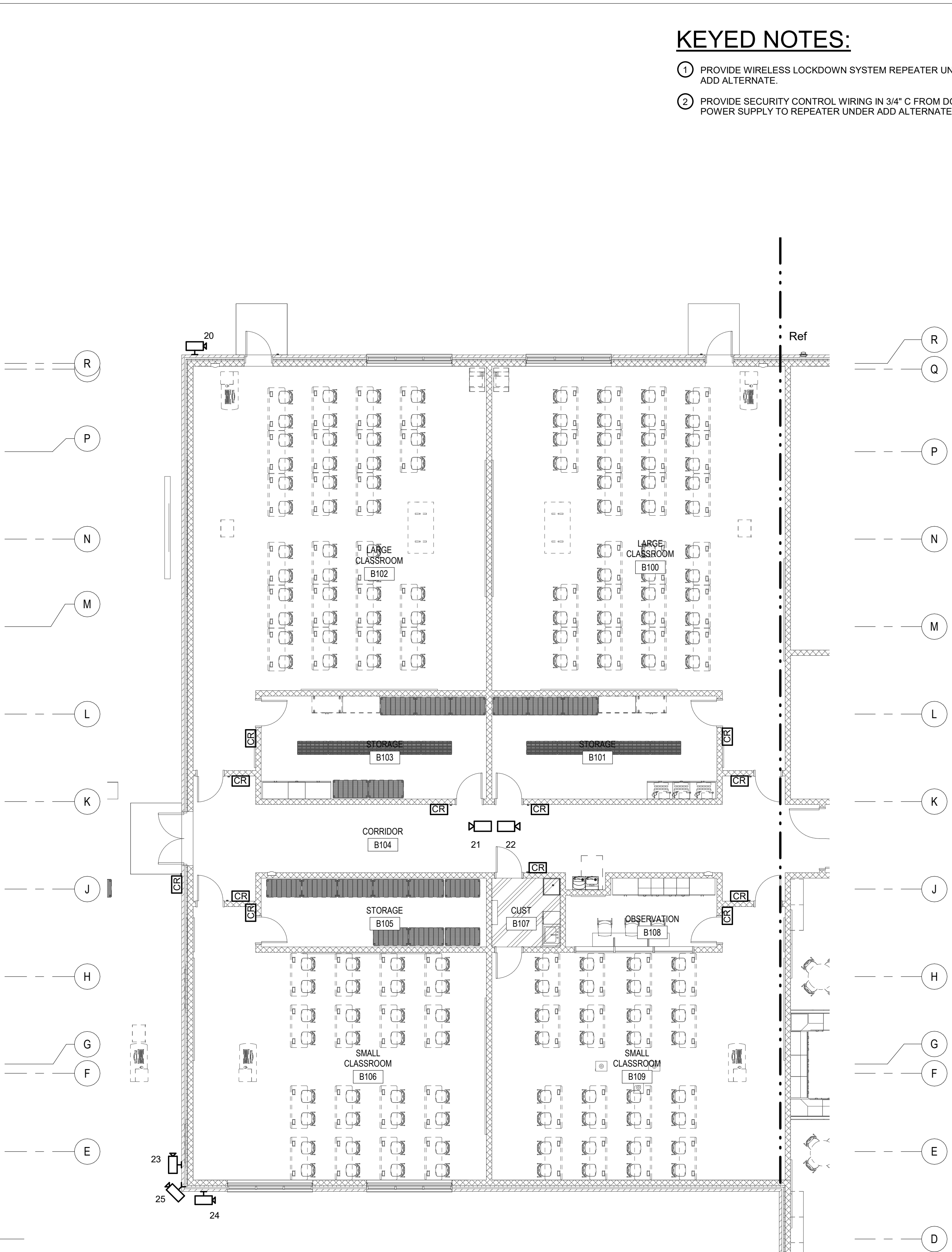

① PARTIAL FIRST FLOOR PLAN - AREA B - SECURITY
1/8" = 1'-0"

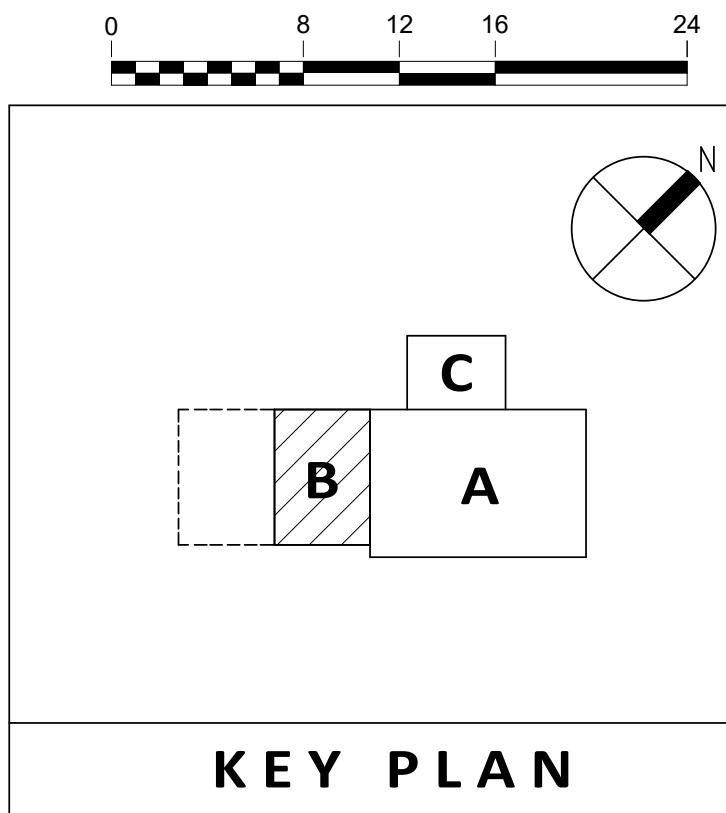

KEYED NOTES:

- ① PROVIDE WIRELESS LOCKDOWN SYSTEM REPEATER UNDER ADD ALTERNATE.
- ② PROVIDE SECURITY CONTROL WIRING IN 3/4" C FROM DOOR POWER SUPPLY TO REPEATER UNDER ADD ALTERNATE.

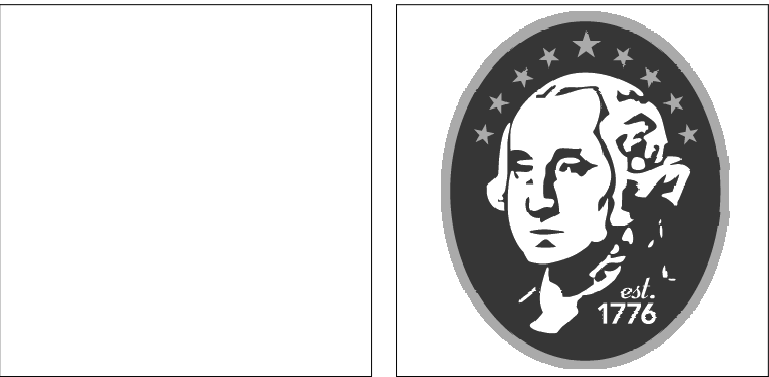

ALL REPORTS, PLANS SPECIFICATIONS AND COMPUTER FILES RELATING TO THIS PROJECT ARE THE PROPERTY OF CRABTREE, ROHRBAUGH & ASSOCIATES. CRABTREE ROHRBAUGH & ASSOCIATES RETAINS ALL COMMON LAW, STATUTE AND OTHER RESERVED RIGHTS INCLUDING THE COPYRIGHT THEREOF. REPRODUCTION OF THE MATERIAL HEREIN OR SUBSTANTIAL USE WITHOUT WRITTEN PERMISSION OF CRABTREE, ROHRBAUGH & ASSOCIATES VIOLATES THE COPYRIGHT LAWS OF THE UNITED STATES AND WILL BE SUBJECT TO LEGAL PROSECUTION. © CRABTREE, ROHRBAUGH & ASSOCIATES, INC. 2019

REVISIONS

NO.	MM-DD-YR	NAME	DESCRIPTION OF CHANGES
1	12/18/2019		BID DOCUMENTS

CRABTREE ROHRBAUGH & ASSOCIATES - ARCHITECTS

100 WEST ROAD, SUITE 402, TOWSON MD 21204 410-528-0272
MECHANICSBURG, PENNSYLVANIA CHARLOTTEVILLE, VIRGINIA WHITE SULPHUR SPRINGS, WEST VIRGINIA

PROPOSED NEW
WASHINGTON COUNTY PUBLIC SAFETY TRAINING CENTER
WASHINGTON COUNTY PROJECT NO. 28-266
18350 PUBLIC SAFETY PLACE
HAGERSTOWN, MD 21740



PARTIAL FIRST FLOOR PLAN - AREA B - SECURITY
PLOT SCALE:
1/8" = 1'-0"
FILENAME:
DATE:
DECEMBER 18, 2019

PROJECT
3089

T2.2

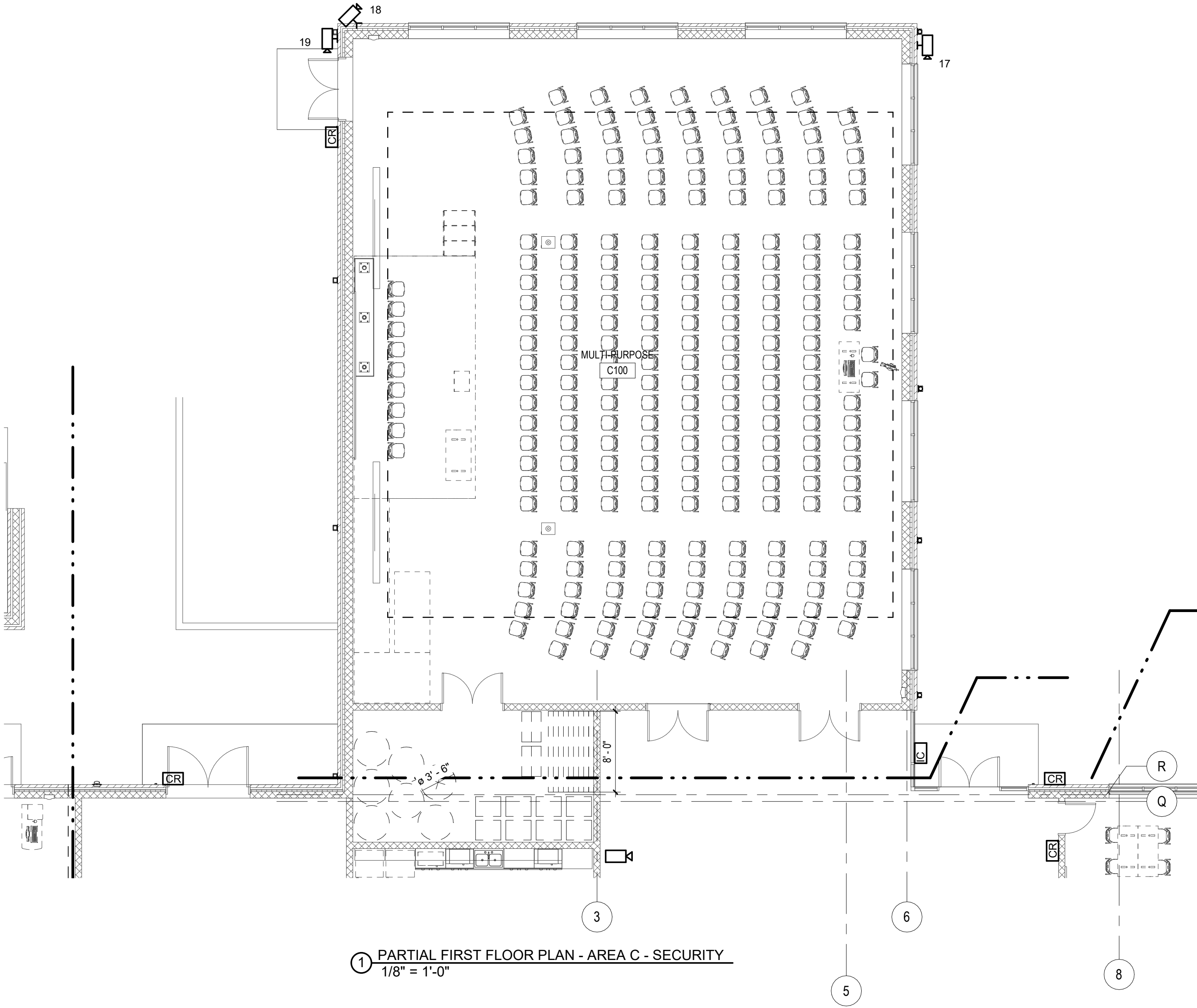

1 PARTIAL FIRST FLOOR PLAN - AREA C - SECURITY
1/8" = 1'-0"

GENERAL NOTES:

- WHERE CABLING CANNONT BE CONCEALED FROM VIEW, PROVIDE PAINTED CONDUITS FOR CABLING RUNNING IN EXPOSED CEILING AREAS INCLUDING MULTIPURPOSE ROOM C100.

KEYED NOTES:

- PROVIDE WIRELESS LOCKDOWN SYSTEM GATEWAY AND REPEATER UNDER ADD ALTERNATE.
- PROVIDE SECURITY CONTROL WIRING IN 3/4" C FROM DOOR POWER SUPPLY TO REPEATER UNDER ADD ALTERNATE.



ALL REPORTS, PLANS SPECIFICATIONS AND COMPUTER FILES RELATING TO THIS PROJECT ARE THE PROPERTY OF CRABTREE, ROHRBAUGH & ASSOCIATES. CRABTREE ROHRBAUGH & ASSOCIATES RETAINS ALL COMMON LAW, STATUTE AND OTHER RESERVED RIGHTS INCLUDING THE COPYRIGHT THEREIN. REPRODUCTION OF THE MATERIAL HEREIN OR SUBSTANTIAL USE WITHOUT WRITTEN PERMISSION OF CRABTREE, ROHRBAUGH & ASSOCIATES VIOLATES THE COPYRIGHT LAWS OF THE UNITED STATES AND WILL BE SUBJECT TO LEGAL PROSECUTION. © CRABTREE, ROHRBAUGH & ASSOCIATES, INC. 2019

REVISIONS

NO.	MM-DD-YR	NAME	DESCRIPTION OF CHANGES
1	12/18/2019		BID DOCUMENTS

CRABTREE ROHRBAUGH & ASSOCIATES - ARCHITECTS

100 WEST ROAD, SUITE 402, TOWSON MD 21204 410-528-0272
MECHANICSBURG, PENNSYLVANIA CHARLOTTEVILLE, VIRGINIA WHITE SULPHUR SPRINGS, WEST VIRGINIA

PROPOSED NEW
WASHINGTON COUNTY PUBLIC SAFETY TRAINING CENTER
WASHINGTON COUNTY PROJECT NO. 28-266
18350 PUBLIC SAFETY PLACE
HAGERSTOWN, MD 21740

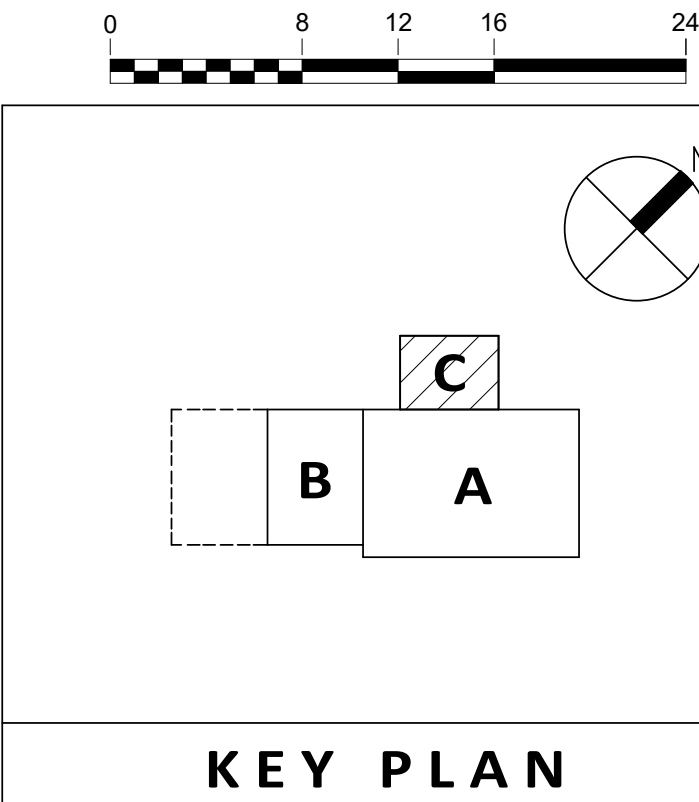

PARTIAL FIRST FLOOR PLAN - AREA C - SECURITY
PLOT SCALE:
1/8" = 1'-0"
FILENAME:
DATE:
DECEMBER 18, 2019

PROJECT
3089

T2.3



1. THIS DETAIL APPLIES TO ALL NEW RACKS AND CABINETS BEING PROVIDED.



ALL CONDUCTORS SHALL BE
COPPER CONDUCTORS

TBC TELECOMMUNICATIONS BONDING CONDUCTOR
#6 AWG UNLESS OTHERWISE NOTED.

MBC TELECOMMUNICATIONS MAIN BONDING CONDUCTOR
#2 / 0 AWG.

TBB TELECOMMUNICATIONS BONDING BACKBONE
2 / 0 AWC

TGB TELECOMMUNICATIONS GROUND BAR
MOUNTED ON BACKBOARD, SEE DETAIL.

TMGB TELECOMMUNICATIONS MAIN GROUND BAR
MOUNTED ON BACKBOARD, SEE DETAIL.

ERB EQUIPMENT RACK BUSBER. MOUNT ON THE REAR SIDE OF EACH RACK. AT THE TOP. SEE DETAIL.

SCALE : NONE

NOTES:

1. RUN ALL GROUND CONDUCTORS IN THIS SYSTEM IN TELECOM PRIMARY AND SECONDARY PATHWAYS TO EXTEND FEASIBLE.



4

NOTES:
1. TYPICAL RUSBARS, INSULATORS AND BACKBOARD MOUNT BRACKETS SHOWN HERE REFLECT TIA STANDARDS-COMPLIANT DIMENSIONS.
2. MOUNT BACKBOARD-MOUNTED BUSBARS @ 6'-6" A-F UNLESS DIRECTED OTHERWISE BY OWNER

- ① PROVIDE 50 PAIR CAT 6 FOR VOICE.
- ② PROVIDE 24 MULTIMODE (50 MICRON LASER OPTIMIZED OM3) AND 24 STRAND SINGLEMODE FIBER BETWEEN MPOD AND MDF WITH 'LC' CONNECTORS.
- ③ NOT USED.
- ④ PROVIDE TWO 4" CONDUITS BETWEEN EACH IDF RM AND MDF RM C105.
PROVIDE (3) 1-1/4" INNERDUCTS IN EACH CONDUIT.
- ⑤ 25-PAIR CAT 6 FOR VOICE/INTERCOM BACKBONE BETWEEN MDF AND IDF.
- ⑥ (2) 4-PAIR CAT 6 FOR DATA BETWEEN MDF AND EACH IDF.



NO SCALE

NOTES:

TGB = TELECOMMUNICATIONS GROUNDING BUSBAR
TGB = TELECOMMUNICATIONS MAIN GROUNDING BUSBAR
TGB = TELECOMMUNICATIONS BONDING BACKBONE
ALL BONDING CABLE IS #6AWG STRANDED COPPER
WGREN JACKET WITH TELECOM ROOM
WGREN CLOSET BONDING CAB. IS CONNECTED TO INTERCOM
BACKBONE CABLE AS A COUPLED BONDING CONDUCTOR (CBC) SHALL BE #10 AWG
PRIMARY TELEPHONE UTILITY (C/O.) PROTECTION BY VERIZON
(LOCATED IN MAIN ELECTRICAL ROOM) (NOT ILLUSTRATED)
DOWNSPEAKER CIRCUIT SHIELDS ARE GROUND AT TGB'S OR
TGB'S RESPECTIVELY CAFETERIA, GYMNASIUM, AUDITORIUM &
MISC. SOUND SYSTEM CABINETS ARE LOCALLY GROUND VIA
AC POWER SYSTEM (NOT ILLUSTRATED).

NO SCALE

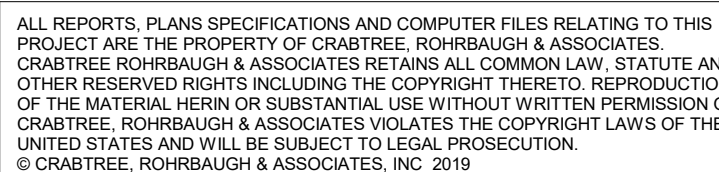
[illegible]

ARCHITECTS

www.cra-architects.com
SPRINGS, WEST VIRGINIA

100 WEST ROAD, SUITE 402, TOWSON MD 21204 410-528-0272

MECHANICSBURG, PENNSYLVANIA CHARLOTTESVILLE, VIRGINIA WHITE SULPHUR SPRINGS, WEST VIRGINIA

PROPOSED NEW

WASHINGTON COUNTY PUBLIC SAFETY TRAINING CENTER

WASHINGTON COUNTY PROJECT NO. 28-266

18350 PUBLIC SAFETY PLACE
HAGERSTOWN, MD 21740



RISERS - TELECOM

PLOT SCALE:

$$1/8'' = 1'-0''$$

FILENAME:

DATE: DECEMBER 18, 2019

PROJECT
3089

T3.1

REF.	CABLE	DESCRIPTION	CONDUCTORS	SHIELDING
A	*25293B	1 TWISTED, SHIELDED PAIR.	#18 AWG STRANDED	FOIL W/BARE DRAIN WIRE.
B	*25359B	1 TWISTED SHIELDED PAIR + 1 TWISTED PAIR.	#20 AWG STRANDED	FOIL W/BARE DRAIN WIRE.
C	*25510	2 PAIR INDIVIDUALLY SHIELDED.	#22 AWG STRANDED TINNED.	COMMON DRAIN WIRE
D	*25225	2 TWISTED CONDUCTORS	#16 AWG	NONE
F	*D253652	3 TWISTED SHIELDED PAIR	#22 AWG	OVERWALL
G		CLOCK CIRCUIT	#14 AWG	NONE
I	*25302	(2) 3 CONDUCTORS	#20 AWG	OVERALL
M	*25292B	1 TWISTED, SHIELDED PAIR.	#20 AWG STRANDED	FOIL W/BARE DRAIN WIRE.
S	*25226B	1 TWISTED PAIR	#14 AWG STRANDED	NONE
T	*25294B	1 TWISTED, SHIELDED PAIR.	#16 AWG	FOIL W/BARE DRAIN WIRE.

NOTES:

1. USE ONLY THE CABLE LISTED OR EQUAL, APPROVED BY EQUAL
2. * - WEST PENN CABLE
3. DO NOT RUN MICROPHONE AND SPEAKER CABLES IN THE SAME CONDUIT.



ALL REPORTS, PLANS, SPECIFICATIONS AND COMPUTER FILES RELATING TO THIS PROJECT ARE THE PROPERTY OF CRABTREE, ROHRBAUGH & ASSOCIATES. CRABTREE ROHRBAUGH & ASSOCIATES RETAINS ALL COMMON LAW, STATUTE AND OTHER RESERVED RIGHTS INCLUDING THE COPYRIGHT THERETO. REPRODUCTION OF THE MATERIAL HEREIN OR SUBSTANTIAL USE WITHOUT WRITTEN PERMISSION OF CRABTREE, ROHRBAUGH & ASSOCIATES VIOLATES THE COPYRIGHT LAWS OF THE UNITED STATES AND WILL BE SUBJECT TO LEGAL PROSECUTION.
© CRABTREE, ROHRBAUGH & ASSOCIATES, INC 2019

REVISIONS

[illegible]

**CRABTREE ROHRBAUGH & ASSOCIATES -
ARCHITECTS**

www.cra-architects.com
ROCK SPRINGS, WEST VIRGINIA

WASHINGTON COUNTY PUBLIC SAFETY TRAINING CENTER

WASHINGTON COUNTY PROJECT NO. 28-266

18350 PUBLIC SAFETY PLACE
HAGERSTOWN, MD 21740



DETAILS - TELECOM

PLOT SCALE:
1/8" = 1'-0"

FILENAME:

DATE: DECEMBER 18, 201

PROJECT
3089

T4.1

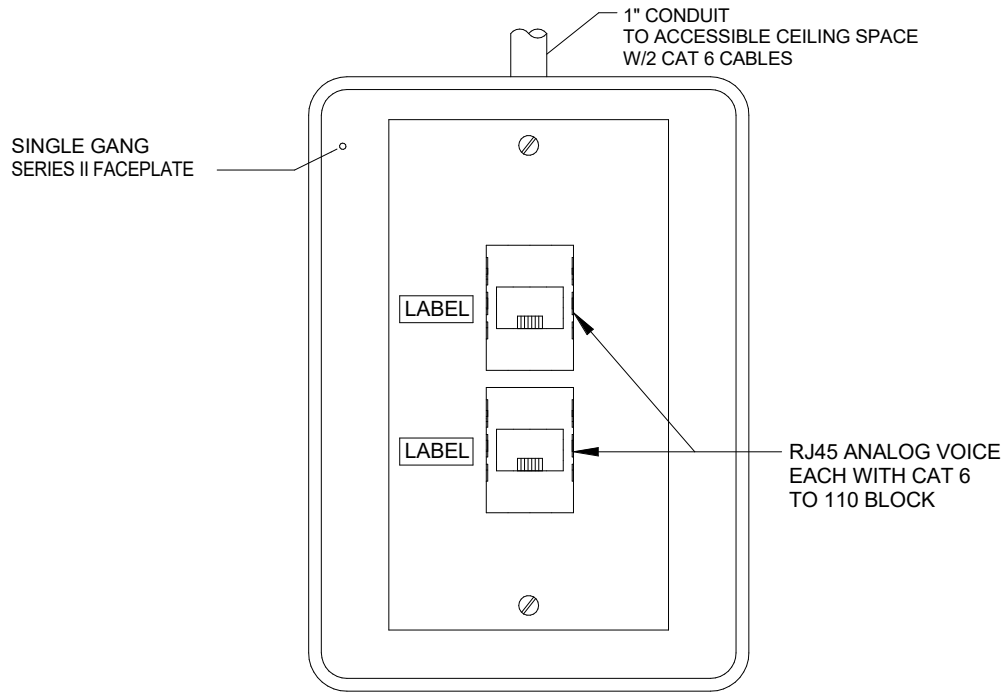

6 TYPICAL TELEPHONE OUTLET ▼2

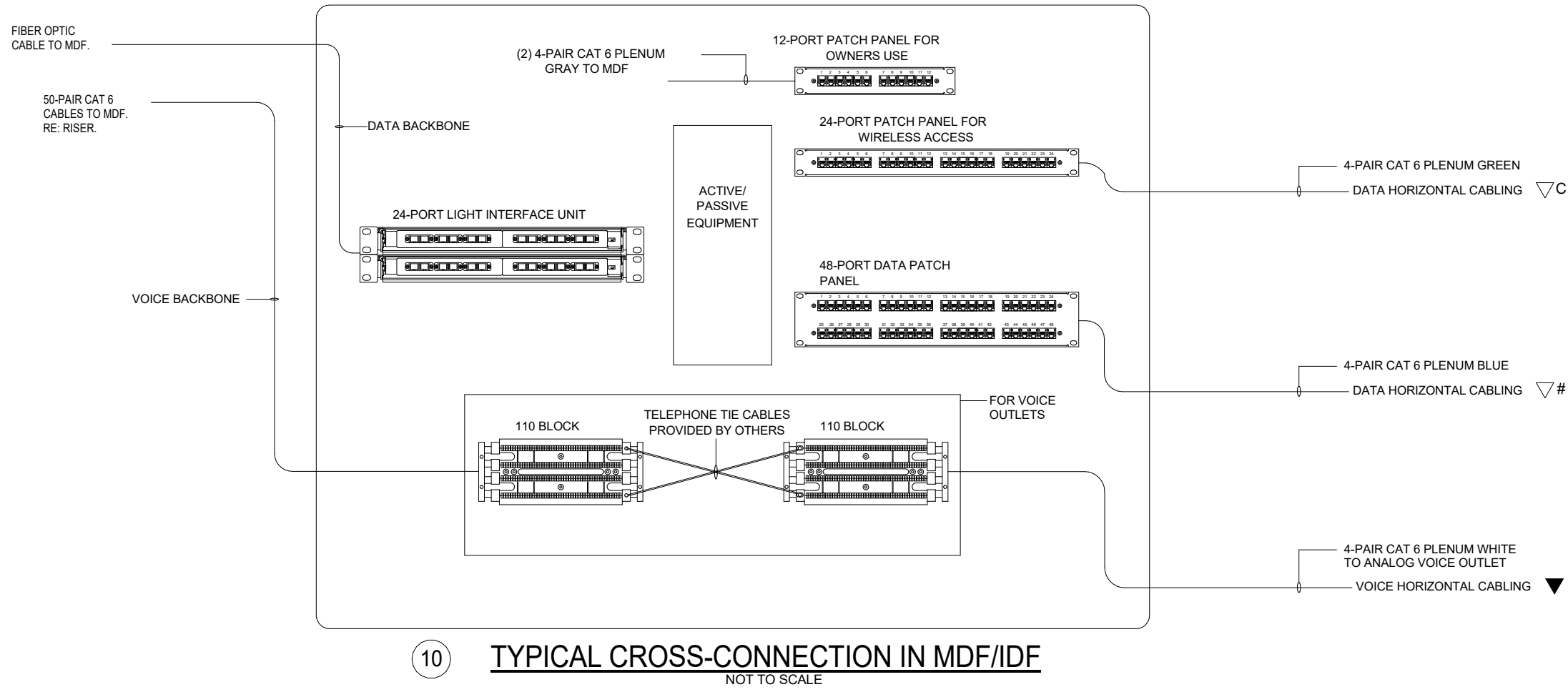
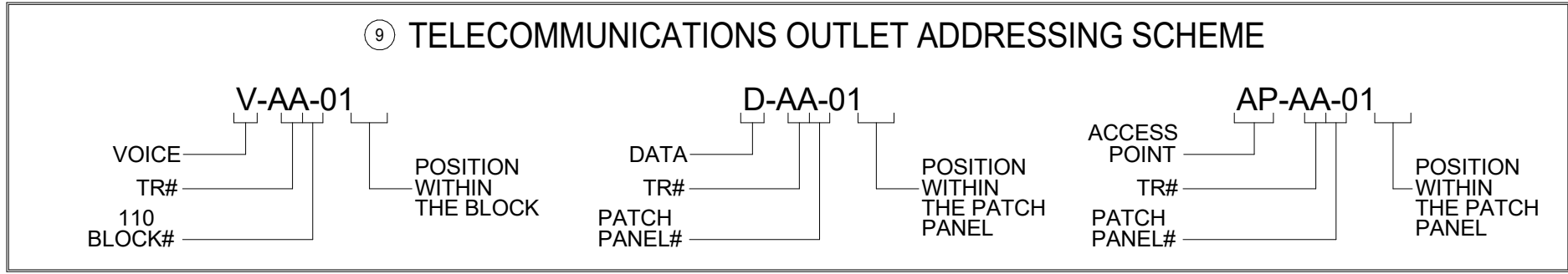

10 TYPICAL CROSS-CONNECTION IN MDF/IDF NOT TO SCALE

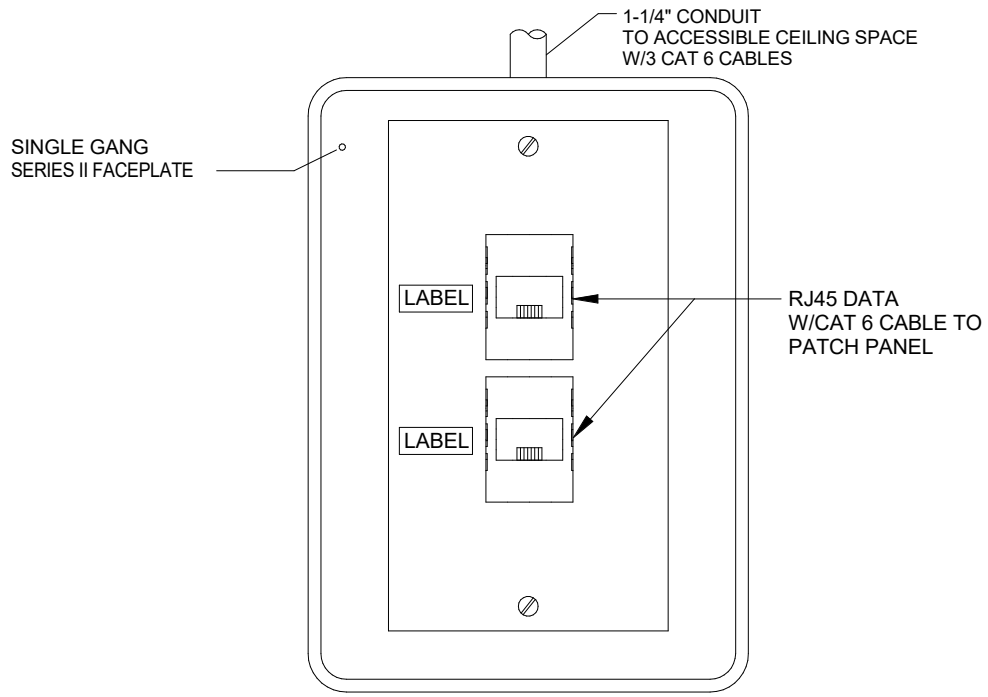

3 TYPICAL DUAL OUTLET ▼2

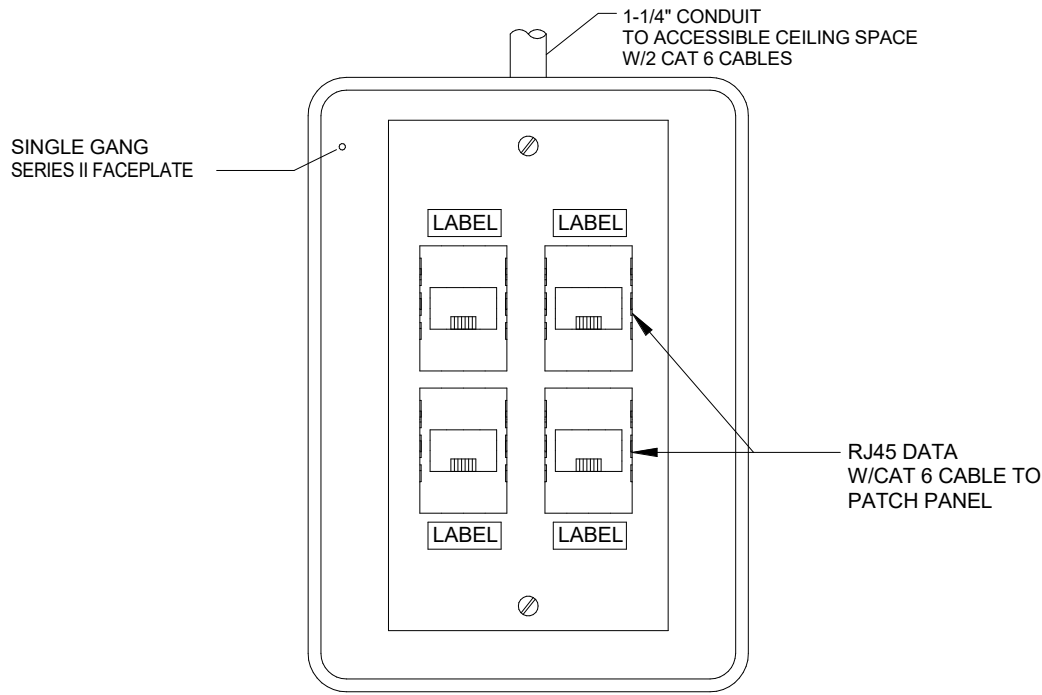

4 TYPICAL QUAD OUTLET ▼4

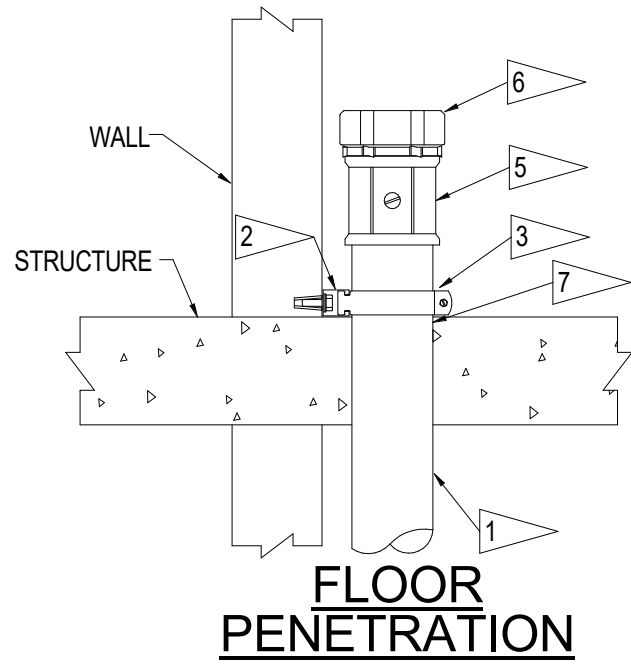

FLOOR PENETRATION

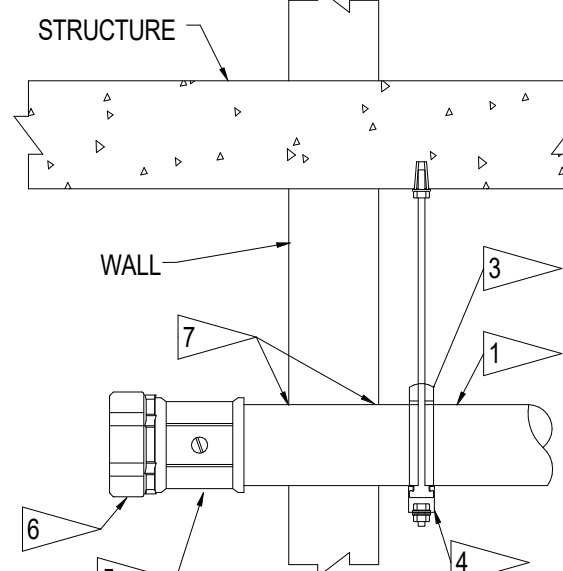

WALL PENETRATION

13 RISER CONDUIT END FITTINGS DETAIL NO SCALE

KEYNOTES:

- 4" EMT CONDUIT, USE COMPRESSION COUPLINGS AND FITTINGS UNLESS OTHERWISE NOTED.
- 1-1/2"x1-1/2" 12 GA. KINDORF CHANNEL - ANCHOR SECURELY TO WALL.
- 4" EMT STRAPS (KINDORF #C-105-4).
- KINDORF CHANNEL AND STRAP SUPPORT - ANCHOR SECURELY TO DECK ABOVE.
- 4" DIE CAST SET SCREW CONNECTOR (RACO #2646). FOR ALL CONDUIT SMALLER THAN 4", USE COMPRESSION CONNECTOR.
- 4" PLASTIC INSULATING BUSHING (RACO #1416). INSTALL INSULATING, BONDING AND GROUNDING BUSHING AT CLOSEST END OF CONDUIT.
- FIRESTOP AS REQUIRED BY FIRE CODE.

GENERAL NOTES:

- PENETRATE TELECOMMUNICATIONS ROOM 4" TO 8" MAXIMUM.
- SIMILAR FOR ALL SIZE EMT CONDUITS.

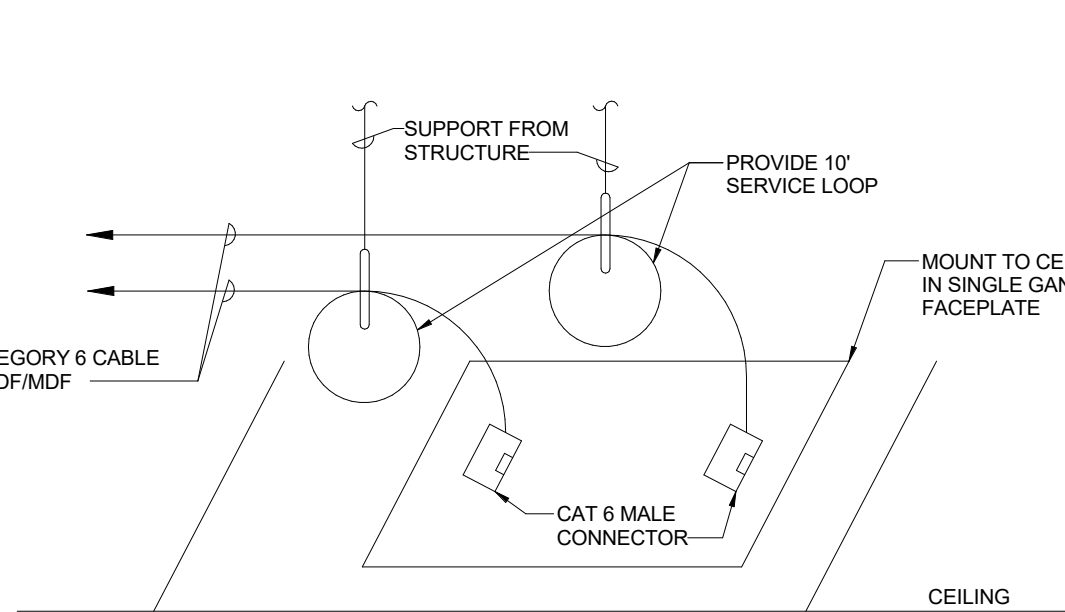

11 WIRELESS ACCESS CONNECTION DETAIL NO SCALE

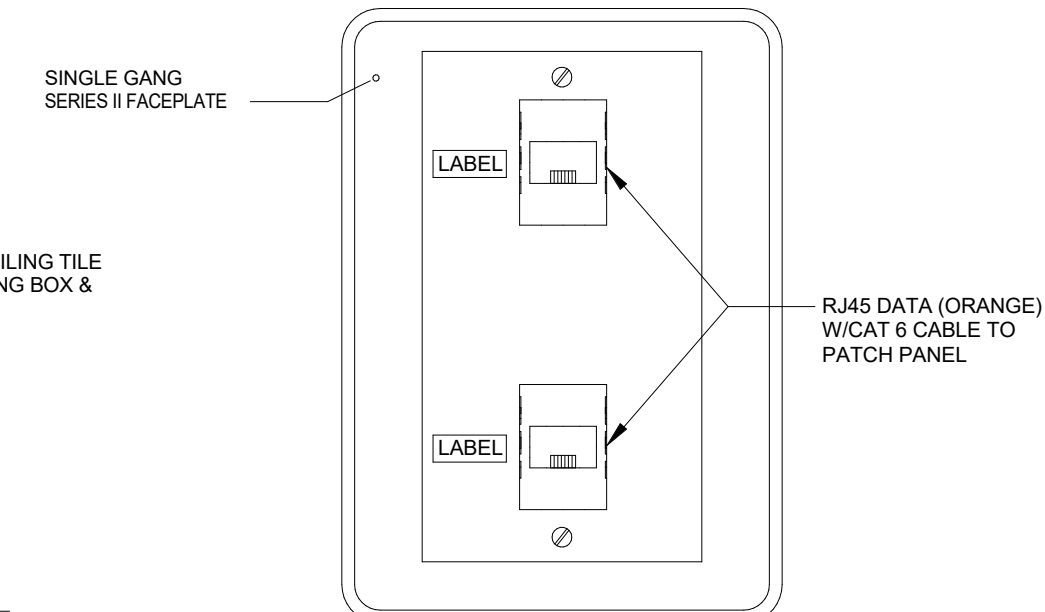

12 WIRELESS FACEPLATE DETAIL

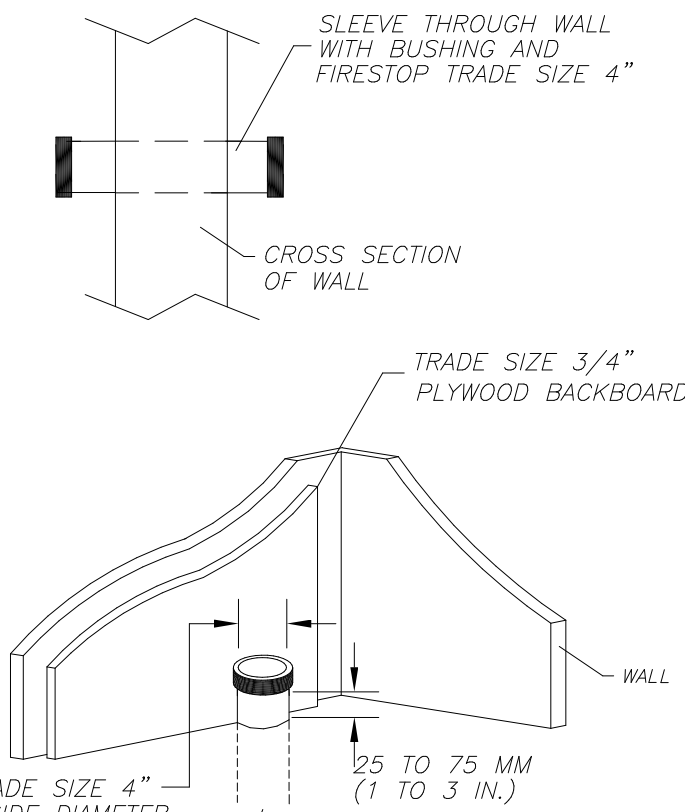

14 SLEEVE/CONDUIT DETAILS NO SCALE

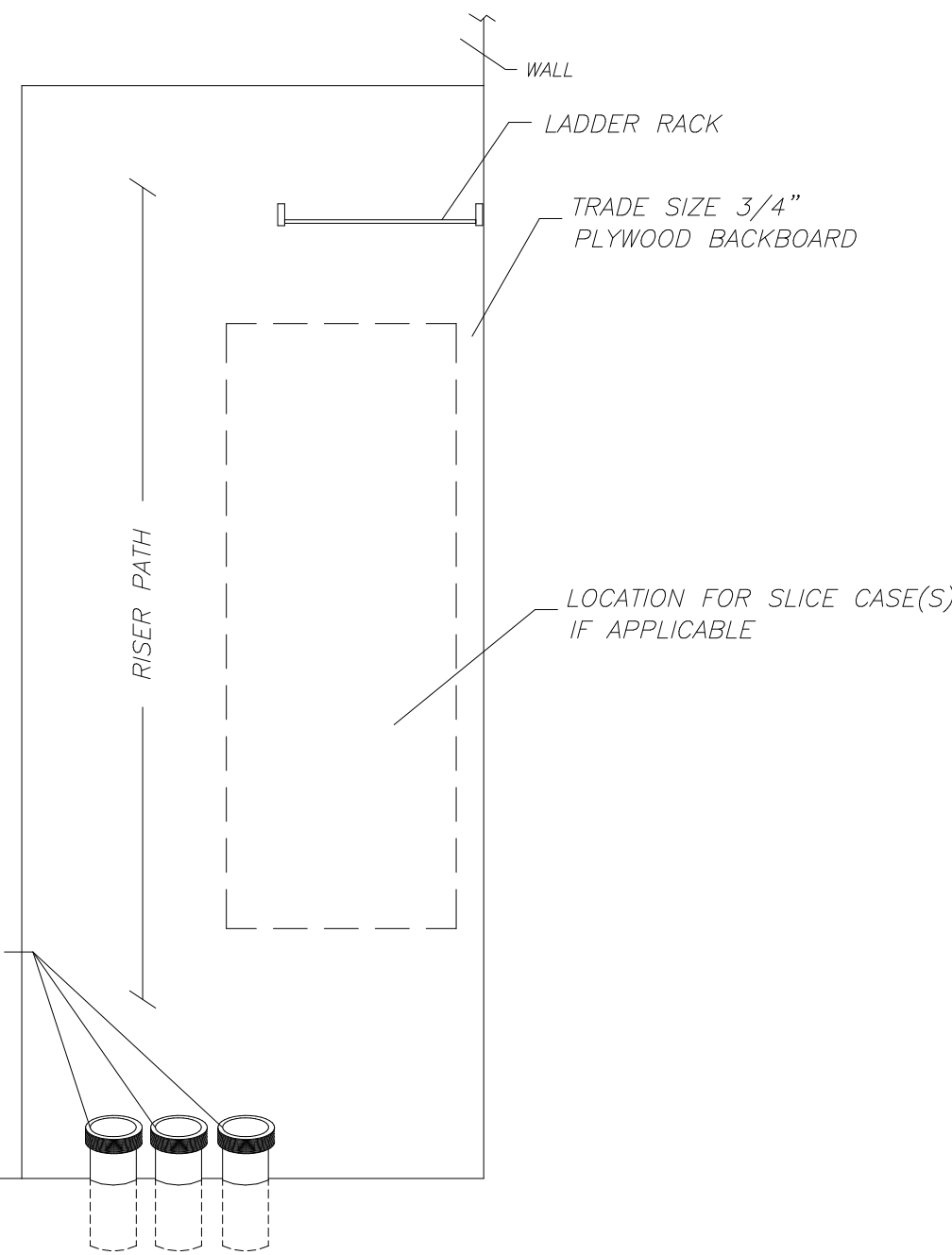

15 RISE BACKBOARD ELEVATION NO SCALE

CRABTREE ROHRBAUGH & ASSOCIATES -

ARCHITECTS

100 WEST ROAD, SUITE 402, TOWSON MD 21204 410-528-0272
MECHANICSBURG, PENNSYLVANIA CHARLOTTEVILLE, VIRGINIA WHITE SULPHUR SPRINGS, WEST VIRGINIA

www.cra-architects.com

PROPOSED NEW

WASHINGTON COUNTY PUBLIC SAFETY TRAINING CENTER

WASHINGTON COUNTY PROJECT NO. 28-266

18350 PUBLIC SAFETY PLACE
HAGERSTOWN, MD 21740



DETAILS - TELECOM

PLOT SCALE:

1/8" = 1'-0"

FILENAME:

DATE:

DECEMBER 18, 2019

PROJECT
3089

T4.2

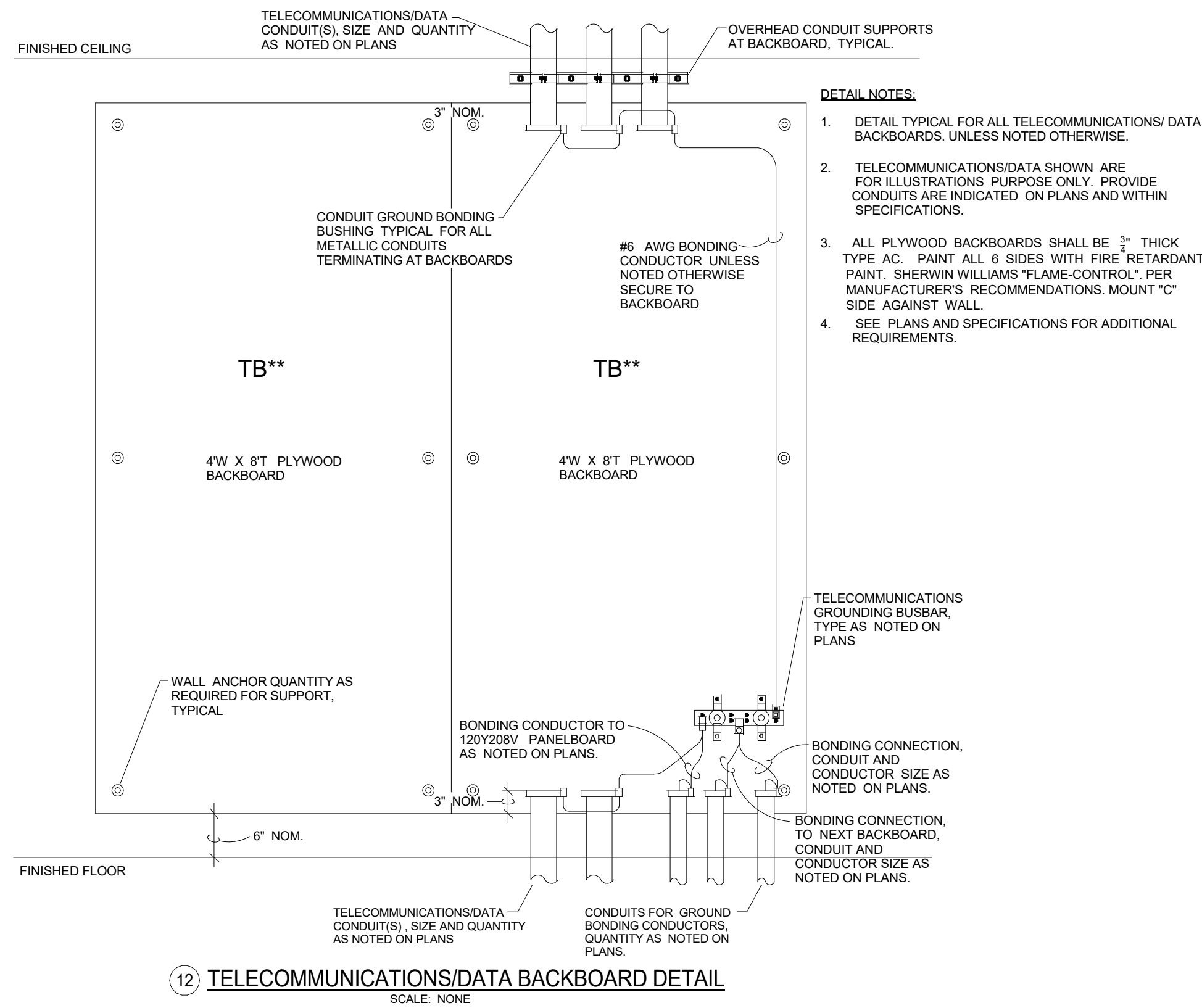
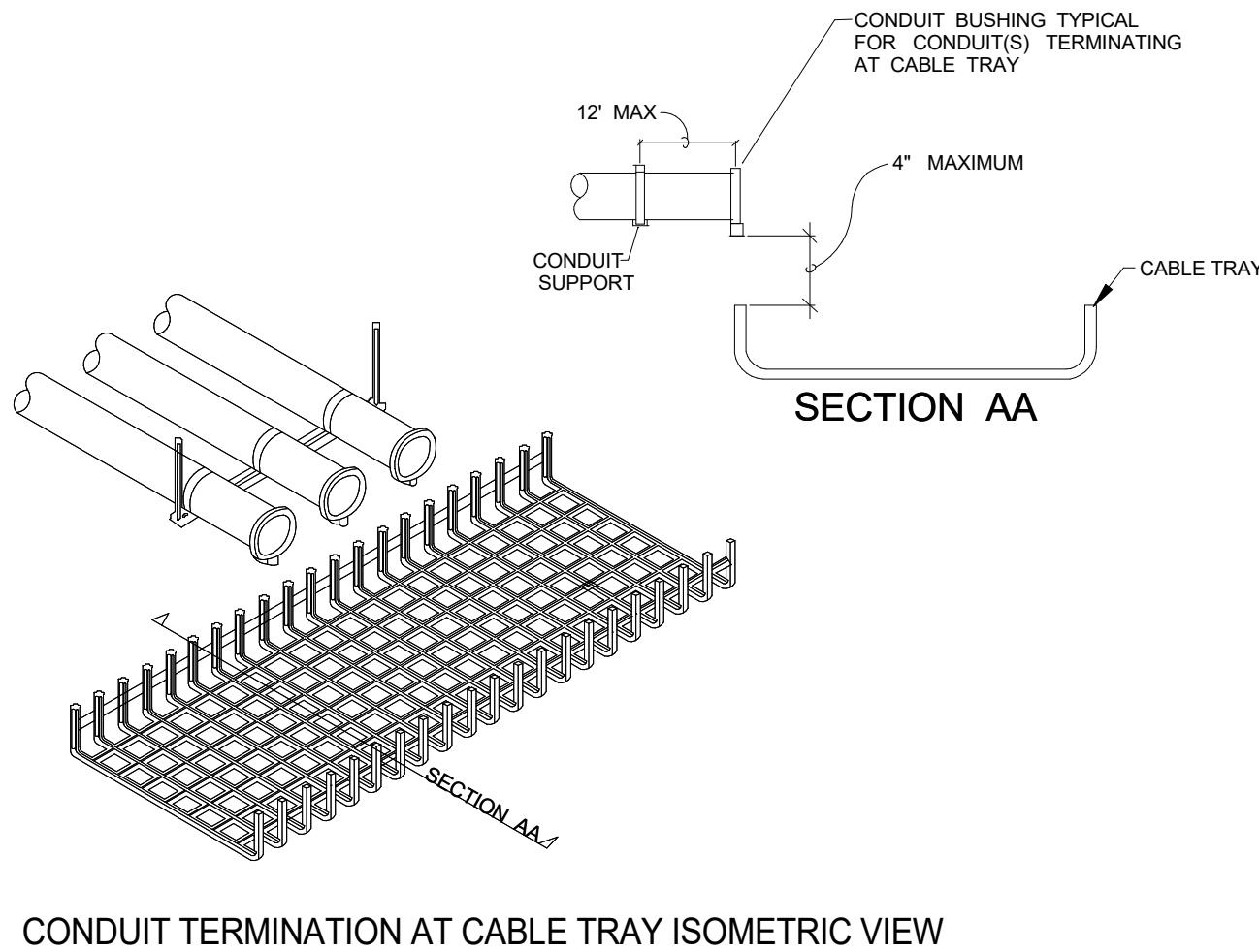
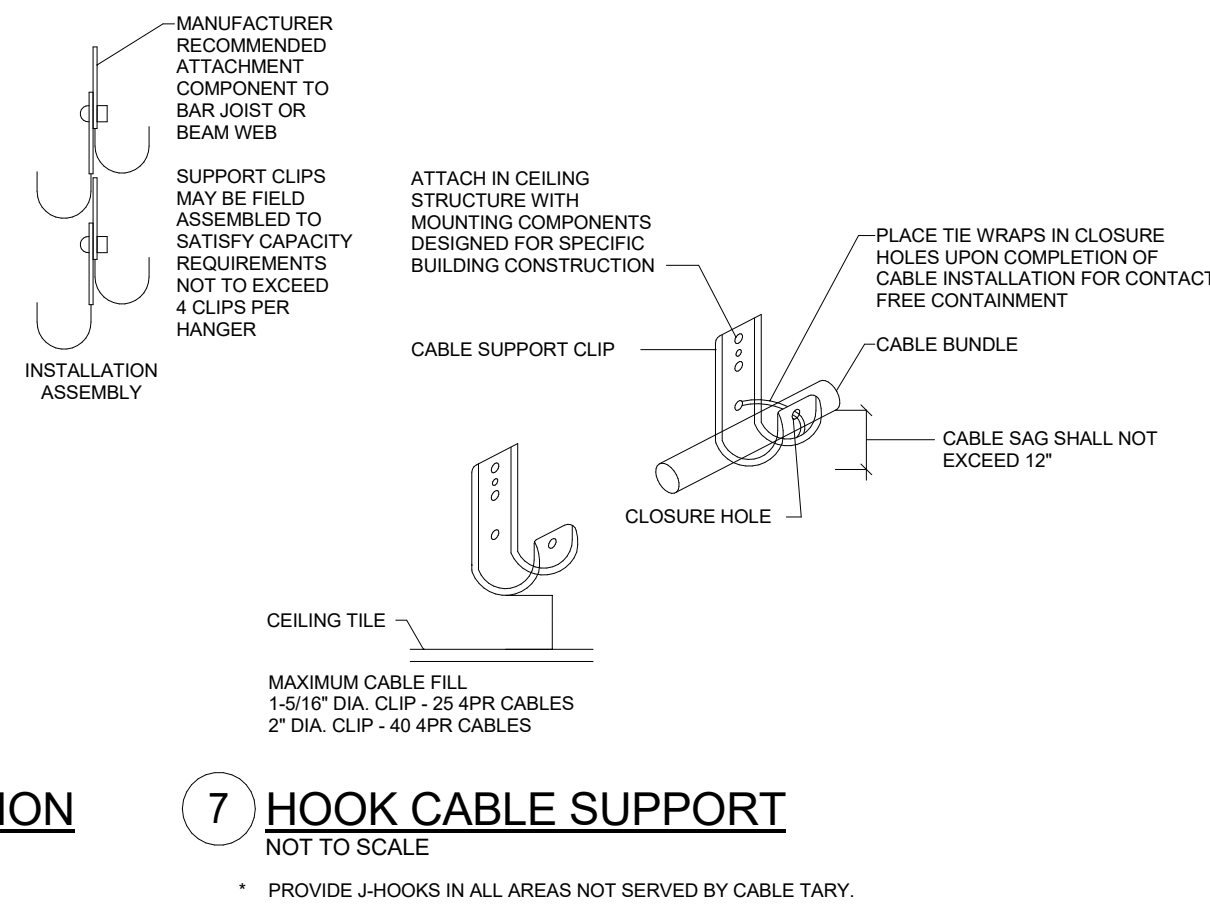
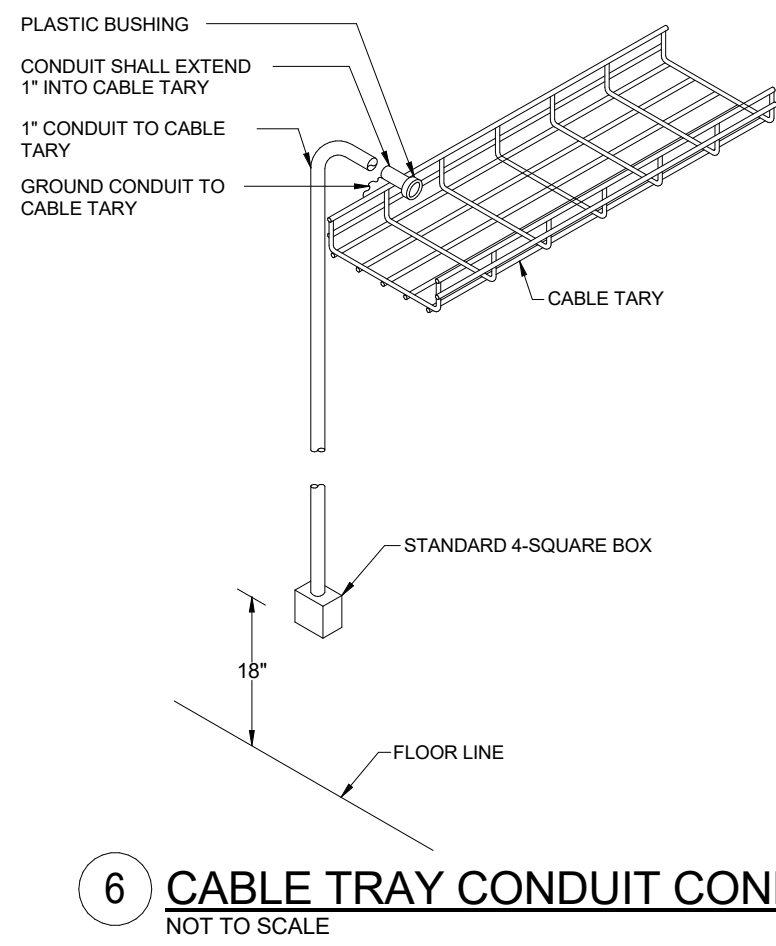
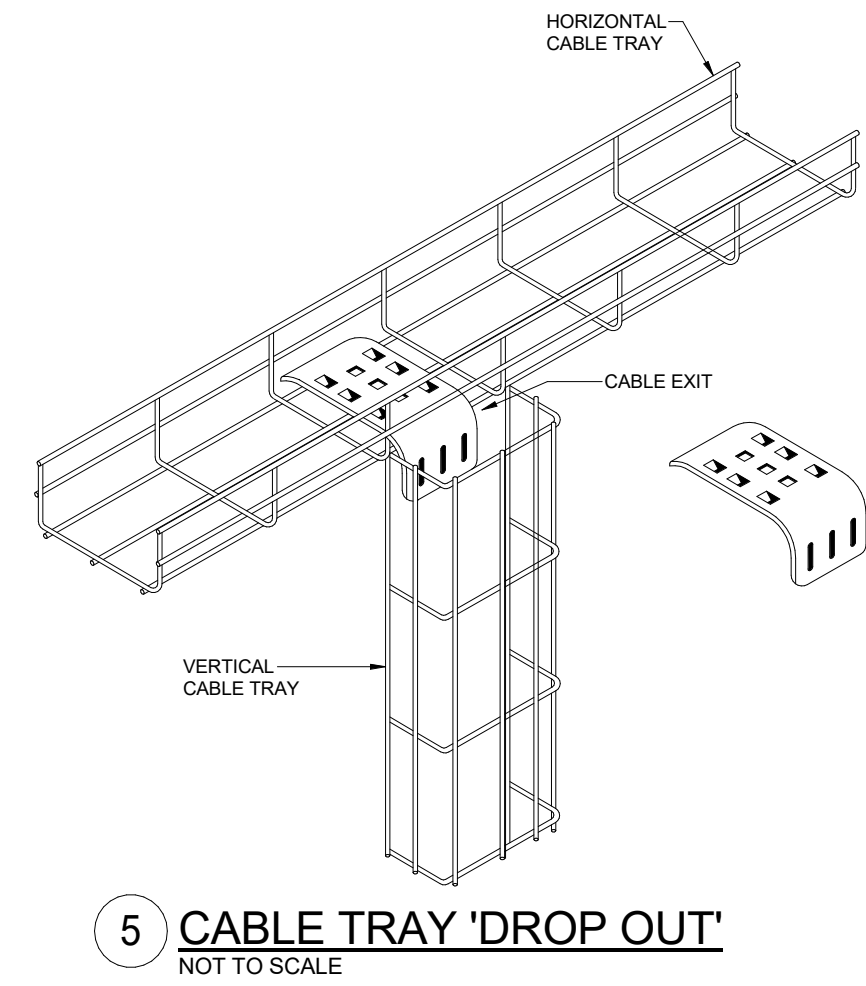
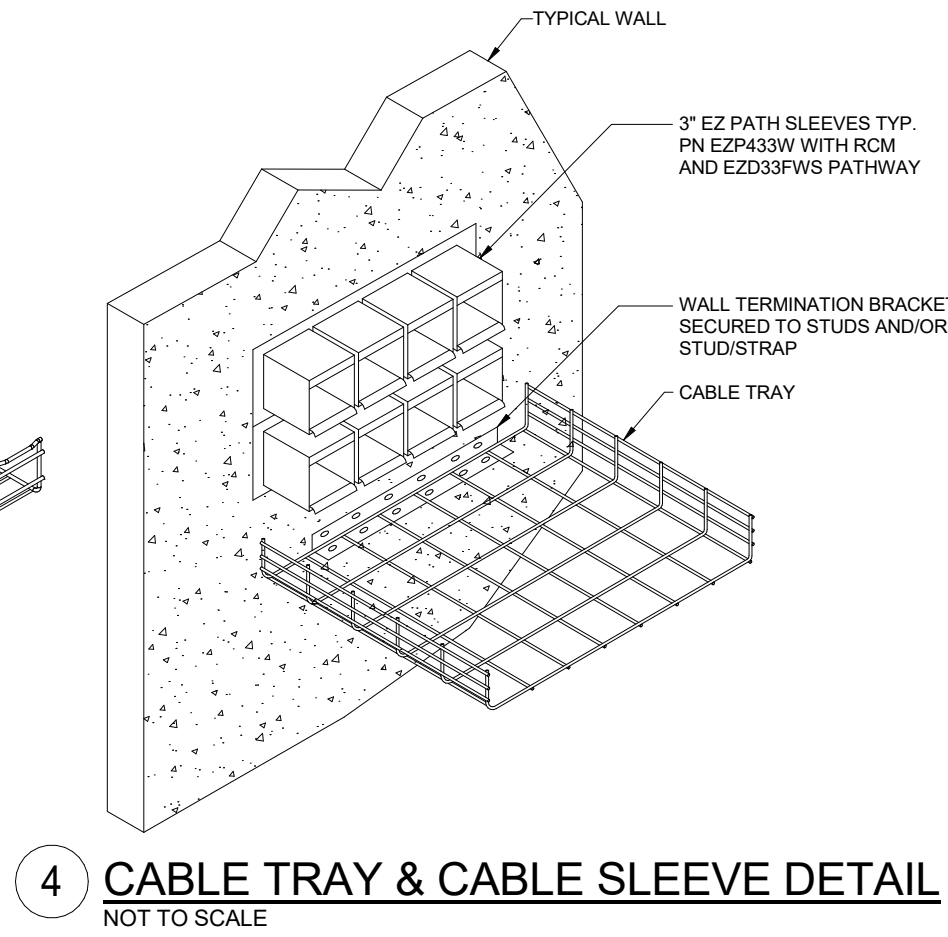
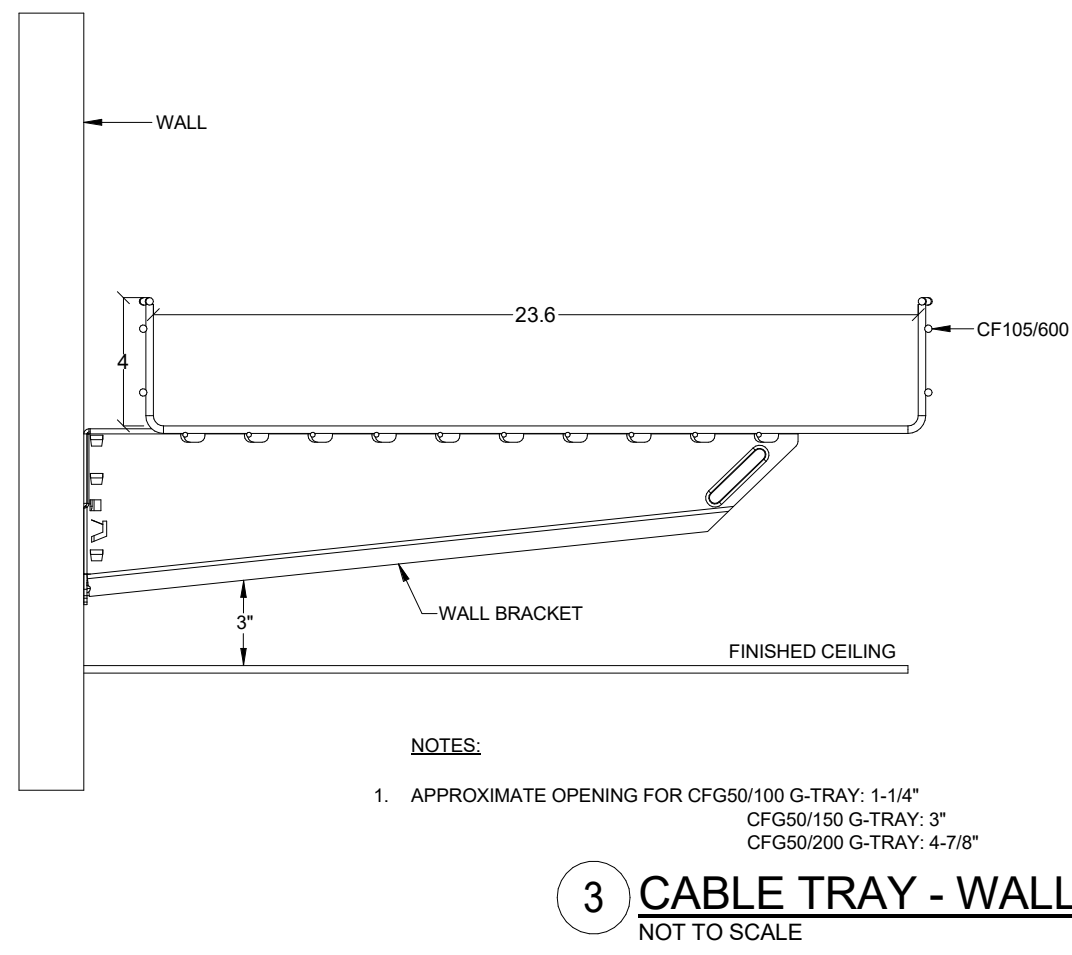
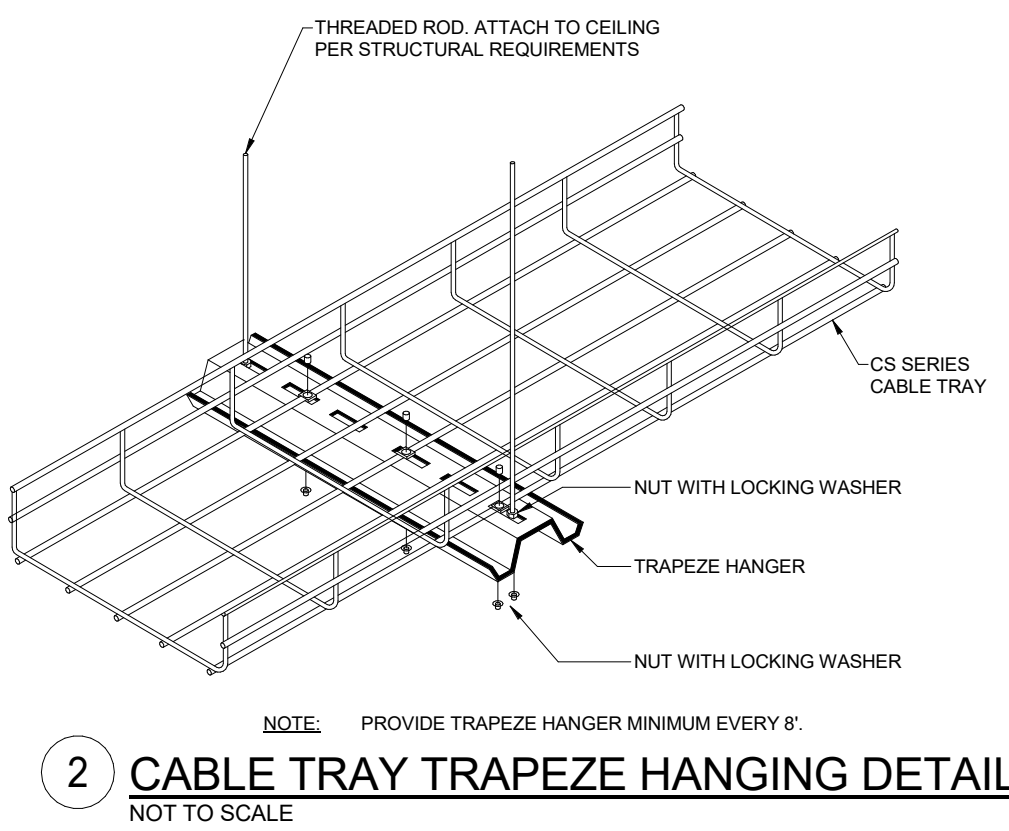
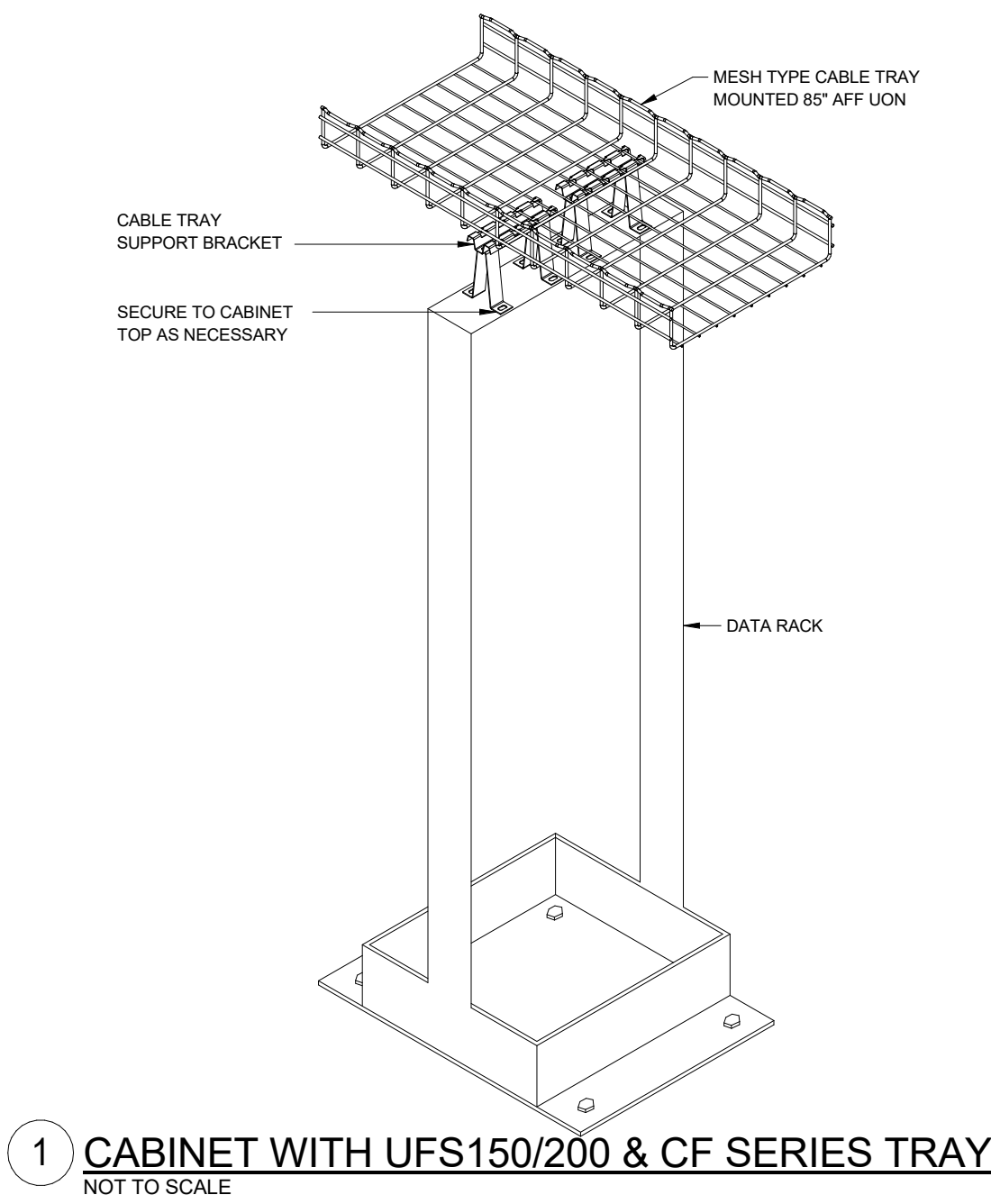

CRABTREE ROHRBAUGH & ASSOCIATES - ARCHITECTS
100 WEST ROAD, SUITE 402, TOWSON MD 21204 410-528-0272
MECHANICSBURG, PENNSYLVANIA CHARLOTTEVILLE, VIRGINIA WHITE SULPHUR SPRINGS, WEST VIRGINIA
www.cra-architects.com

PROPOSED NEW
WASHINGTON COUNTY PUBLIC SAFETY TRAINING CENTER
WASHINGTON COUNTY PROJECT NO. 28-266
18350 PUBLIC SAFETY PLACE
HAGERSTOWN, MD 21740



DETAILS - TELECOM
PLOT SCALE:
1/8" = 1'-0"
FILENAME:
DATE:
DECEMBER 18, 2019

PROJECT
3089

T4.3

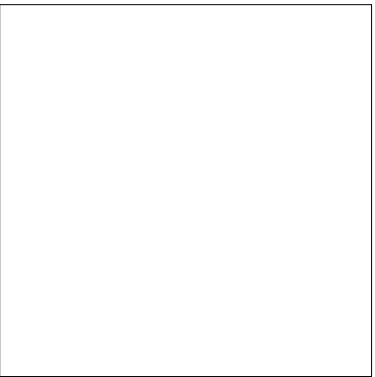

ALL REPORTS, PLANS SPECIFICATIONS AND COMPUTER FILES RELATING TO THIS PROJECT ARE THE PROPERTY OF CRABTREE, ROHRBAUGH & ASSOCIATES. CRABTREE ROHRBAUGH & ASSOCIATES RETAINS ALL COMMON LAW, STATUTE AND OTHER RESERVED RIGHTS INCLUDING THE COPYRIGHT THEREIN. REPRODUCTION OF THE MATERIAL HEREIN OR SUBSTANTIAL USE WITHOUT WRITTEN PERMISSION OF CRABTREE, ROHRBAUGH & ASSOCIATES VIOLATES THE COPYRIGHT LAWS OF THE UNITED STATES AND WILL BE SUBJECT TO LEGAL PROSECUTION. © CRABTREE, ROHRBAUGH & ASSOCIATES, INC. 2019

REVISIONS

NO.	MM-DD-YR	NAME	DESCRIPTION OF CHANGES
1	12/18/2019		BID DOCUMENTS

CRABTREE ROHRBAUGH & ASSOCIATES - ARCHITECTS

100 WEST ROAD, SUITE 402, TOWSON MD 21204 410-528-0272
MECHANICSBURG, PENNSYLVANIA CHARLOTTEVILLE, VIRGINIA WHITE SULPHUR SPRINGS, WEST VIRGINIA

www.cra-architects.com

PROPOSED NEW
WASHINGTON COUNTY PUBLIC SAFETY TRAINING CENTER
WASHINGTON COUNTY PROJECT NO. 28-266
18350 PUBLIC SAFETY PLACE
HAGERSTOWN, MD 21740



DETAILS - TELECOM

PLOT SCALE:
1/8" = 1'-0"
FILENAME:
DATE:
DECEMBER 18, 2019

PROJECT
3089

T4.5

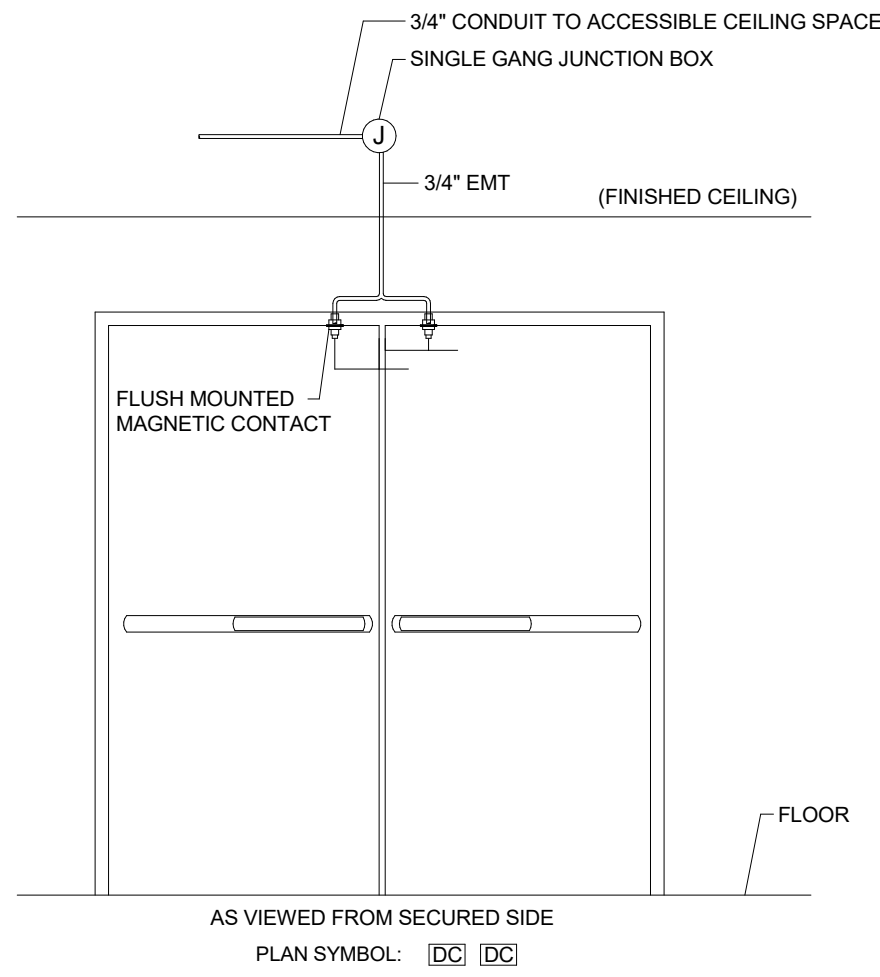
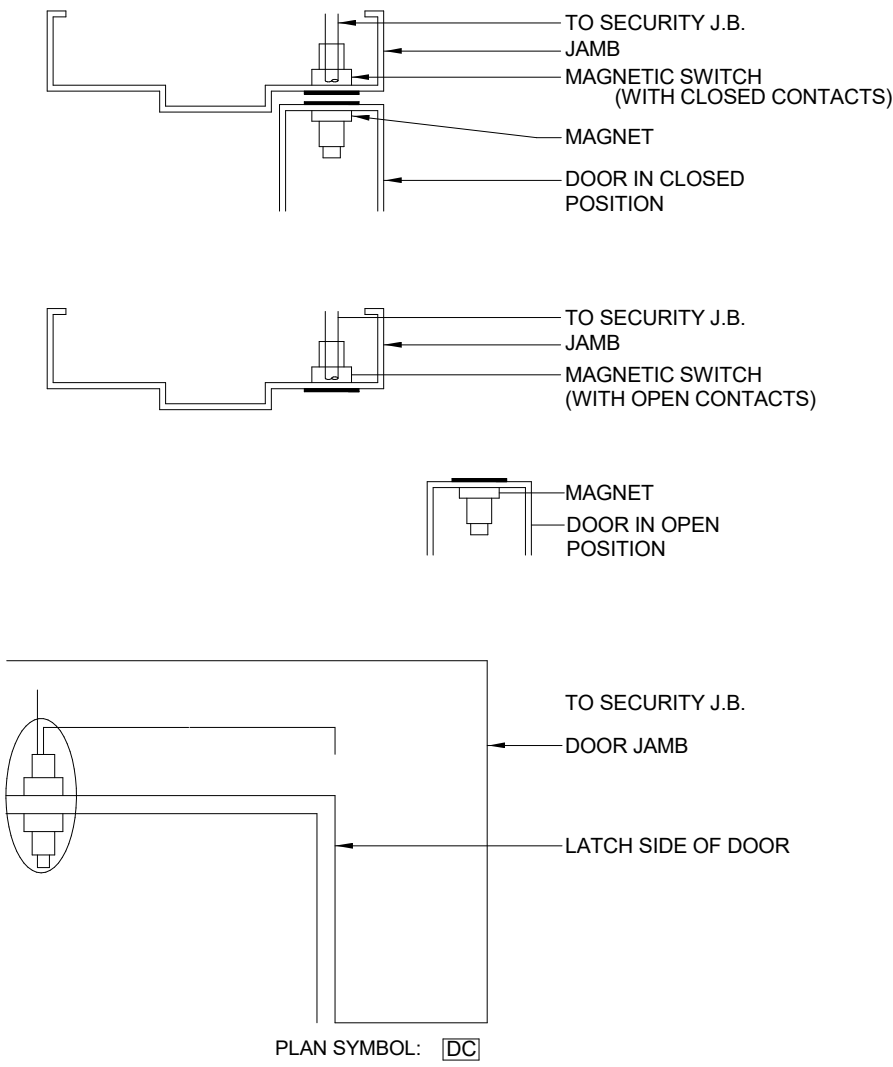
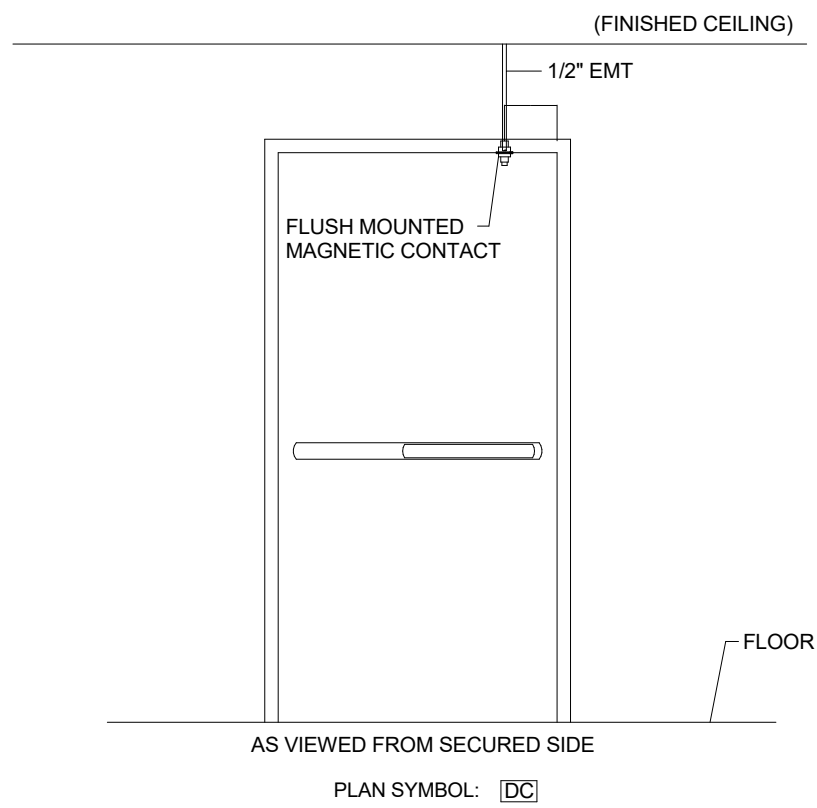

1 SINGLE DOOR ALARM CONTACT PLACEMENT

NO SCALE

2 RECESSED ALARM CONTACT

NO SCALE

3 DOUBLE DOOR ALARM CONTACT

NO SCALE

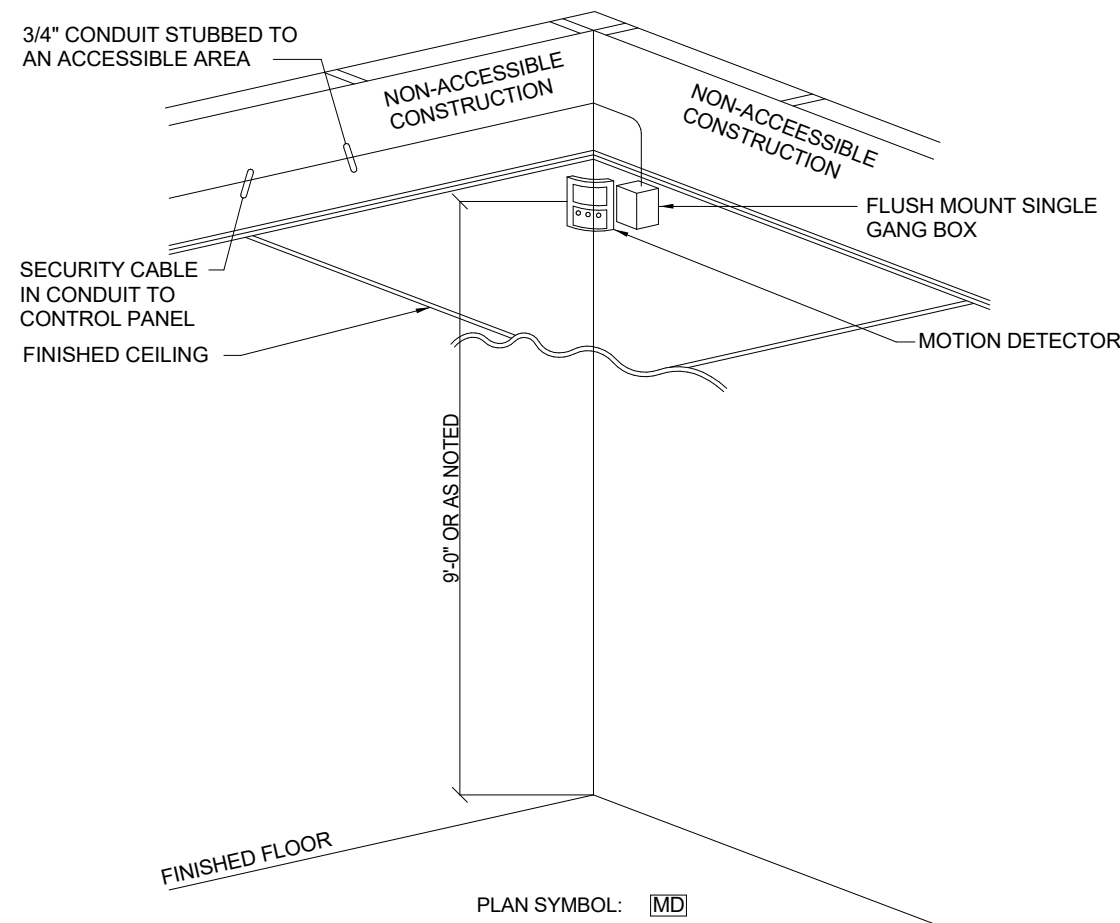

4 MOTION DETECTOR NON-ACCESSIBLE CEILING ELEVATION TYPICAL DETAIL

NO SCALE

5 MOTION DETECTOR ACCESSIBLE CEILING ELEVATION TYPICAL DETAIL

NO SCALE

